

MARINE SPECIALTIES



MAN SHIP
Machinery & Hardware co., Ltd.

Distributor List



Canada

Vertex Marine Inc.
#13-11191 Horseshoe Way,
Richmond, BC V7A 4S5
Ph:604.272.1305
Cell:604.725.2582
Fax:604.272.1309
Email:kweng@vertex-marine.com
Web:www.vertex-marine.com



USA

Hood Yacht Systems (Master Distributor)
7712 Cheri Court
Tampa, Fla 33634
TEL:(813)885-2182
FAX:(813)888-7421
Hood customer service:
Hoodyachtsystems@pompanette.com
website:hoodyachtsystems.com/pompanette.com

Showroom and Parts Locations:

Florida:
1515 Southeast 16th Street
Fort Lauderdale, Florida 33316
Phone:(954)525-6367
California:
893 Production Place
Newport Beach, California 92663
Phone:(949)650-0310



USA

MARINE DEPOT LNC.
14716 Central Ave. Chino, CA91710. U.S.A.
TEL:(909)393-6100
FAX:(909)393-2009
E-mail:info@marinedepotmh.com



USA Service (Repair and Solution)

Select Plastics 219 Liberty Square East
Norwalk CT 06855
TEL:203-886-3767
FAX:203-886-3948
www.selectplastics.com



England

C-Quip LTD
8-Fulcrum One
Solent Way Whiteley Hampshire
UK-PO157FE
TEL:44(0)845-2266 953
44(0)845-2266 954
FAX:44(0)845-2269 133
E-mail:info@cquip.com



France

Greement Import
BP284, 13 Rue Du chene lasse 44803
Saint Herblain France.
TEL:(33)228-030101
FAX:(33)228-031991
E-mail:commande@greementimport.fr



Holland

Belship
Krommewetering 61A3543 AM
Utrecht Holland
TEL:31 30 240 8044
FAX:31 30 241 0832
E-mail:team@belship.nl



Italy

Olcese Ricci s.r.l.
Via E. Caorsi 49, 16031 Sori (GE) Italy
TEL:39 0185 700425
FAX:39 0185 700900
E-mail:info@olcesericci.com



Australia

Deck Hardware
Marine Solutions Australasia
Factory 5, 122-126 Old Pittwater Rd
Brookvale, NSW, 2100, Australia
TEL:(02)9905-9400
FAX:(02)9905-9455
Mail:sales@deckhardware.com.au



Sweden

Egnell Trading AB
Ulrikagatan 5, S-115 23 Stockholm Sweden
TEL:46 8 663 9370
FAX:46 8 663 9894
E-mail:info@egnelltrading.se



Germany

Sailtec Vertriebs GmbH
Hasselbinnen 28. D-22869
Schenefeld bei Hamburg Germany
TEL:49 40 8392013
FAX:49 40 8304279
E-mail:cg@sailtec.de



Turkey

DEKA MARIN DENIZ MALZ. TIC. A.S.
Batli Mah. Sahil Yolu
Istanbul City port Marinturk Marina B-11
34890 Pendik/Istanbul
TEL:+90 216 511 2121
FAX:+90 216 511 2124



UAE

Brook
PO Box 98189, DY 136 Al Jadaf ship
Docking Yard, Dubai UAE
TEL:9714 3244848
Mail:info@brookmarine.com



New Zealand

SO-PAC Marine LTD
8 Volkner Place, Albany,
Auckland 1311. New Zealand.
TEL:(09)448 5900
FAX:(09)448 5911
E-mail:jude@sopac.co.nz



China

Vertex Zhuhai Ltd
Room 820 8th Floor Development Building
NO. 131 Shuiwan Road GongBei District
ZhuHai Guangdong P.R. China
Zip Code:519000
TEL/FAX:86-756-8728001
Email:linklee@vertex-marine.com

CONTENTS

FRICATIVE HINGE DECK HATCH	5
LOW PROFILE DECK HATCH	7
DECK HATCH	9
FRICATIVE HINGE FLUSH HATCH	11
HATCH SKYSCREEN	12
FRICATIVE HINGE PORTS	15
RECTANGULAR OPENING PORTS	16
OVAL OPENING PORTS	17
ROUND OPENING PORTS	18
HEAVY DUTY PORTS	21
OPENING PORTS (H-TRIM)	19
FIXED PORTS	23
VENTILATOR	24
ELLIPTICAL OVAL AND ROUND OPENING PORTS (H-TRIM)	25
OPENING PORTS WITH STORM COVER (H-TRIM)	26

FOLD OUT

CONTENTS

ECONOMY OPENING PORTS (H-TRIM)	27
FIXED TYPE PORTS (H-TRIM)	28
STAINLESS STEEL BOAT WINDOW	29
ALUMINUM BOAT WINDOW	30
ALUMINUM HINGED SLIDING & FIXED PORTS	31
STAINLESS STEEL FLUSH GLASS SALOON DOOR	33
CIRCULAR ARC STAINLESS STEEL SALOON DOOR	35
FRICATIVE HINGE STAINLESS STEEL SALOON DOOR	37
AUTOMATIC SLIDING WINDOW	39
AUTOMATIC OPENING WINDOW	40
DECK FILLS	41
DORADES	42
TV LIFT	43
DOOR CABINET LATCH PUSH BUTTON	45
SPARE PARTS	46

FOLD OUT



FROM MAN SHIP

Man Ship Machinery and Hardware Co., Ltd. is a well-known and respected manufacturer of chandlery and hardware for the international boatbuilding industry and watersport markets since 1982.

We are proud to say that Man Ship quality fittings are found on many of the pleasure boats that are exported from Taiwan each year.

In addition to supplying the O.E.M. market in Taiwan with marine chandlery, we also manufacture exclusive lines for many US based firms. as well as carry an expanding line of our own products.

Our expanding product line includes stainless hatches, stainless portholes, stainless dorades, aluminum boat windows, and yacht fitting.

Our skilled craftsman are fully experienced in producing one-off orders in stainless steel (304 or 316), aluminum extrusions, aluminum castings, zinc and bronze castings.

Man Ship Machinery and Hardware is proud to back its products with a five years warranty for defective material and workmanship to the original consumer purchaser, provided the product has not been misused, altered, or damaged by an accident.

Should you have any questions about our product line, or want to discuss a specialized order, please contact our International Sales or contact with our local agent.

Ali Huang
Managing Director

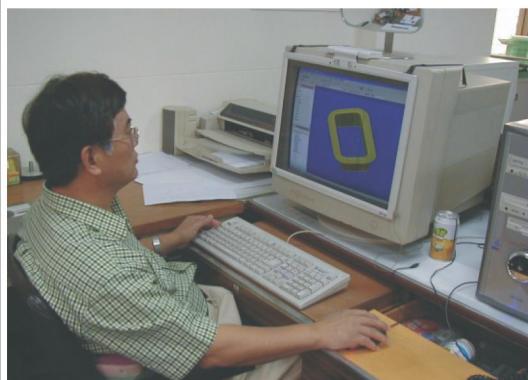

Adopt the latest engineering Auto Cad design.



The unique technique on Tungsten inert Gas welder.

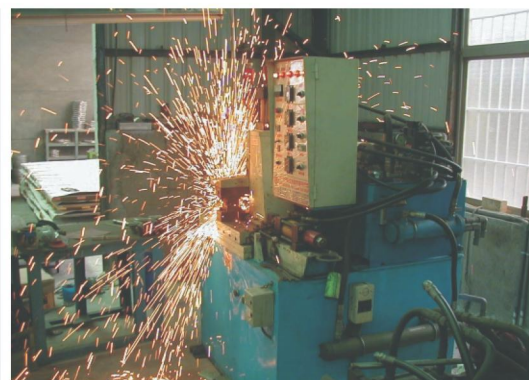

Butt welder ensure excellent welding.



Strict quality inspection.

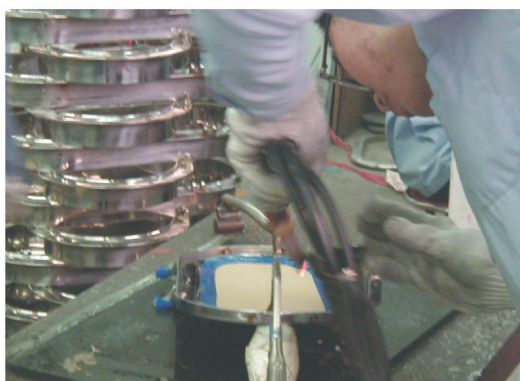

Expert craftsmen are proceeding the welding.



Skill & rigid glue work.

MULTI FUNCTION STAINLESS STEEL HATCHES

- Manship has unique manufacture skill and custom make any shapes and dimensions stainless steel hatches. Please offer details (description & cut out size) for custom hatches, we will provide technical drawing.
- You can contact with our local agent for further information.

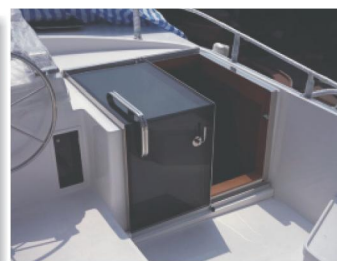

SPECIAL SHAPE PORTLIGHTS

- Manship has unique manufacture skill and custom make any shapes and dimensions stainless steel ports. The ports will pass the quality certification from any boat inspection ossociation. Please offer details(description&cut out size)for custom ports,we will provide technical drawing.
- You can contact with our local agent for further information.

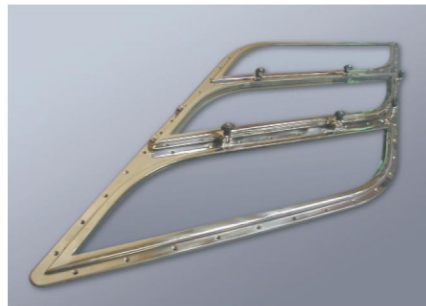

FRICATIVE HINGE DECK HATCH



FRICATIVE HINGE PATENT IN MANY COUNTRIES

New patent design. Unique S/S 316 hinge.
Hatch can be opened at any degree without arm to support.
Easy open or close, water-tight, elegance & durability.

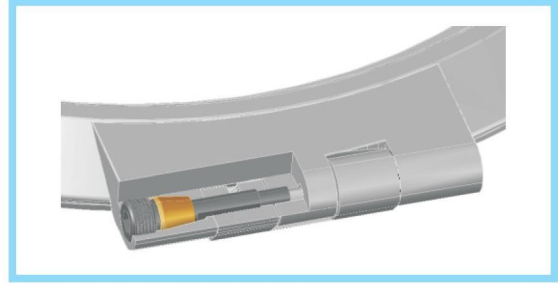

FEATURES

- **CE Approved. According to ISO/DIS 12216 Deck Hatches are approved for Area II, III, and IV, designs for craft type "any" .**
- No bolt holes showing, when hatch is closed.
- 316 stainless steel frames, hatch, and hinges. Hand polished and electro-polished to protect against corrosion. Frames and hatches are made from machine rolled stock to ensure strength and low weight.
- Tough, glare resistant grey acrylic tops.
- Gaskets are oil resistant Sanplane.
- Off-white powder coating are available.



Replace or adjust hatch hinge shaft:
First, pls use 1/8" spanner loosen two set screw inside hinge three turn.
Then use 10mm spanner to adjust both end of hinge patented screw.
After retighten to avoid shake.

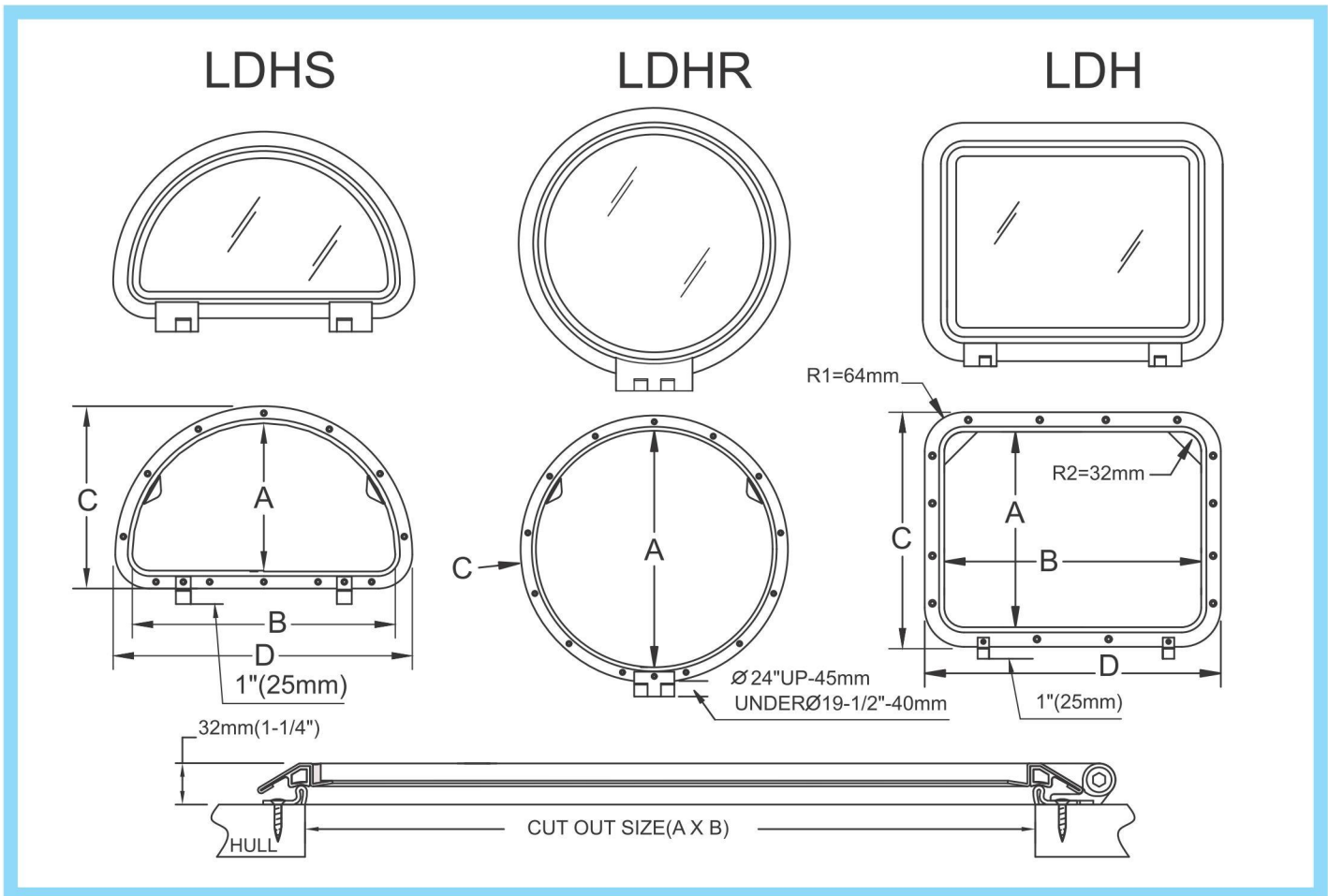

● HATCHES SHOULD BE FITTED TO A FLAT SURFACE WITH A MAXIMUM TOLERANCE OF ± 2 MM.

LDHR



◎ ANY SIZE FOR "A" 16 1/2 - 31"

INSIDE OPENING

PART No.	SIZE		CUTOUT SIZE		OVERALL SIZE		ACRYLIC THICKNESS	WEIGHT
			A		C			
LDHR-40-I	16 1/2	419	16 1/2	419	19	483	1/2 12	6.5KG
LDHR-50-I	19 1/2	495	19 1/2	495	22	559	1/2 12	7.8KG
LDHR-60-I	24	610	24	610	26 1/2	674	1/2 12	10.4KG
LDHR-70-I	31	788	31	788	33 1/2	852	1/2 12	15.8KG

IN/MM

IN/OUTSIDE OPENING

PART No.	SIZE		CUTOUT SIZE		OVERALL SIZE		ACRYLIC THICKNESS	WEIGHT
			A		C			
LDHR-40-O	16 1/2	419	16 1/2	419	19	483	1/2 12	6.6KG
LDHR-50-O	19 1/2	495	19 1/2	495	22	559	1/2 12	7.9KG
LDHR-60-O	24	610	24	610	26 1/2	674	1/2 12	10.6KG
LDHR-70-O	31	788	31	788	33 1/2	852	1/2 12	16.0KG

IN/MM

LDHS



◎ ANY SIZE FOR "A" 16 1/2 - 31"

INSIDE OPENING

PART No.	SIZE		CUTOUT SIZE				OVERALL SIZE				ACRYLIC THICKNESS	WEIGHT
			A	B			C	D				
LDHS-40-I	16 1/2	419	9 1/2	241	16 1/2	419	12	305	19	483	1/2 12	4.8KG
LDHS-50-I	19 1/2	495	11	279	19 1/2	495	13 1/2	343	22	559	1/2 12	6.0KG
LDHS-60-I	24	610	13 1/4	337	24	610	15 3/4	400	26 1/2	674	1/2 12	7.8KG
LDHS-70-I	31	788	16 3/4	425	31	788	19 1/4	489	33 1/2	852	1/2 12	11.5KG

IN/MM

IN/OUTSIDE OPENING

PART No.	SIZE		CUTOUT SIZE				OVERALL SIZE				ACRYLIC THICKNESS	WEIGHT
			A	B			C	D				
LDHS-40-O	16 1/2	(419)	9 1/2	241	16 1/2	419	12	305	19	483	1/2 12	4.9KG
LDHS-50-O	19 1/2	(495)	11	279	19 1/2	495	13 1/2	343	22	559	1/2 12	6.2KG
LDHS-60-O	24	(610)	13 1/4	337	24	610	15 3/4	400	26 1/2	674	1/2 12	8.0KG
LDHS-70-O	31	(788)	16 3/4	425	31	788	19 1/4	489	33 1/2	852	1/2 12	11.6KG

IN/MM

LDH-N



◎ ANY SIZE ARE AVAILABLE, IF R=1 1/4" (32MM) REMAIN UNCHANGED

INSIDE OPENING

PART No.	SIZE		CUTOUT SIZE				OVERALL SIZE				ACRYLIC THICKNESS	WEIGHT
			A	B			C	D				
LDH-N08-I	8 1/8 x 13 3/4	206 x 349	8 1/8	206	13 3/4	349	10 5/8	270	16 1/4	413	1/2 12	4.5KG
LDH-N10-I	10 x 10	254 x 254	10	254	10	254	12 1/2	318	12 1/2	318	1/2 12	4.2KG
LDH-N20-I	12 1/2 x 17 1/2	318 x 444	12 1/2	318	17 1/2	444	15	382	20	508	1/2 12	7.0KG
LDH-N30-I	14 1/2 x 19 1/2	369 x 495	14 1/2	369	19 1/2	495	17	433	22	559	1/2 12	8.0KG
LDH-N40-I	16 1/2 x 16 1/2	419 x 419	16 1/2	419	16 1/2	419	19	483	19	483	1/2 12	7.9KG
LDH-N50-I	19 1/2 x 19 1/2	495 x 495	19 1/2	495	19 1/2	495	22	559	22	559	1/2 12	10KG
LDH-N60-I	24 x 24	610 x 610	24	610	24	610	26 1/2	674	26 1/2	674	1/2 12	12.8KG
LDH-N70-I	31 x 31	788 x 788	31	788	31	788	33 1/2	852	33 1/2	852	1/2 12	19KG

IN/MM

IN/OUTSIDE OPENING

PART No.	SIZE		CUTOUT SIZE				OVERALL SIZE				ACRYLIC THICKNESS	WEIGHT
			A	B			C	D				
LDH-N08-O	8 1/8 x 13 3/4	206 x 349	8 1/8	206	13 3/4	349	10 5/8	270	16 1/4	413	1/2 12	4.6KG
LDH-N10-O	10 x 10	254 x 254	10	254	10	254	12 1/2	318	12 1/2	318	1/2 12	4.3KG
LDH-N20-O	12 1/2 x 17 1/2	318 x 444	12 1/2	318	17 1/2	444	15	382	20	508	1/2 12	7.1KG
LDH-N30-O	14 1/2 x 19 1/2	369 x 495	14 1/2	369	19 1/2	495	17	433	22	559	1/2 12	8.5KG
LDH-N40-O	16 1/2 x 16 1/2	419 x 419	16 1/2	419	16 1/2	419	19	483	19	483	1/2 12	8.3KG
LDH-N50-O	19 1/2 x 19 1/2	495 x 495	19 1/2	495	19 1/2	495	22	559	22	559	1/2 12	10.4KG
LDH-N60-O	24 x 24	610 x 610	24	610	24	610	26 1/2	674	26 1/2	674	1/2 12	13.0KG
LDH-N70-O	31 x 31	788 x 788	31	788	31	788	33 1/2	852	33 1/2	852	1/2 12	19.2KG

IN/MM

LOW PROFILE DECK HATCH

FEATURES Patent no. 111103

- **CE Approved. According to ISO/DIS 12216 Deck Hatches are approved for Area II , III , and IV , designs for craft type "any" .**
- Low profile & elegant appearance.
- No bolt holes showing, when hatch is closed.
- 316 stainless steel frames, hatch, hatch arms and hinges. Hand polished and electro-polished to protect against corrosion. Frames and hatches are made from machine rolled stock to ensure strength and low weight.
- Positive easy to operate stainless arms allowing full 180 degree opening with pull-turn knobs to hold hatch open.
- Adjustable injection molded Nylon 66 handles.
- Set screw adjustment in each hinge to avoid hinge pins coming out.
- Tough, UV resistance of acrylics are available in grey (standard), clear and tint green
- Inside opening, inside/outside opening and double opening available.
- Inside/outside models with 100% Stainless Steel snag free handle.
- Double opening models with quick snap-release dogs and 100% stainless fast pins for easy and quick change of hinge location.
- Gaskets are oil resistant Sanplane.
- Off-white powder coating are available.
- Standard Arm can be changed to Gas arm if needed.

INSIDE OPENING



IN/OUTSIDE OPENING HATCH WITH LOCK



Acrylic colors available



Grey



Clear



Tint Green

LOW PROFILE DECK HATCH



IN/OUTSIDE OPENING



DOUBLE OPENING

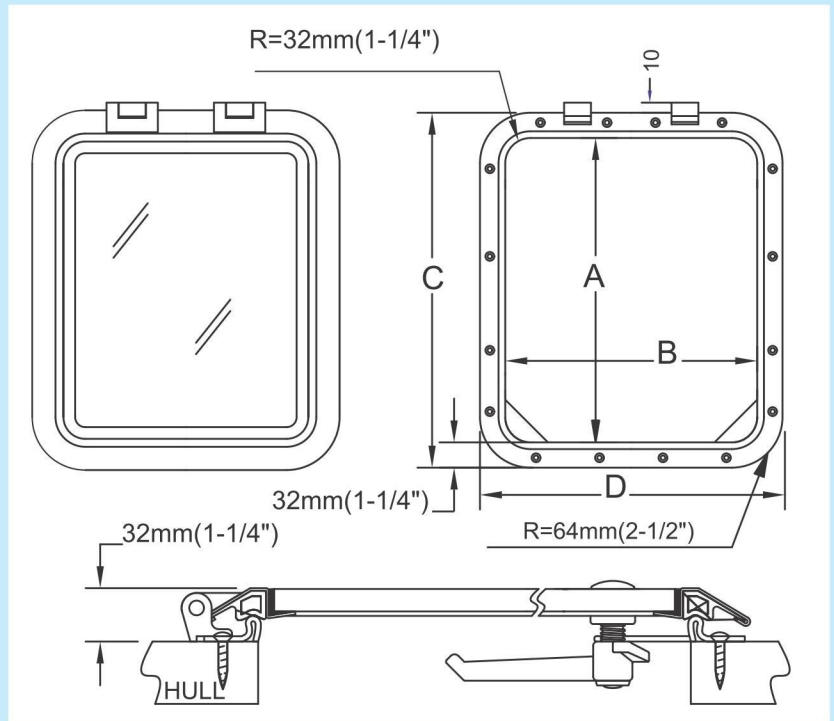

- ANY SIZE FOR "A" AND "B" AVAILABLE, IF R = 1 1/4" (32MM) REMAIN UNCHANGED.
- HATCHES SHOULD BE FITTED TO A FLAT SURFACE WITH A MAXIMUM TOLERANCE OF ±2MM.

INSIDE OPENING

PART No.	SIZE		CUTOUT SIZE		OVERALL		ACRYLIC THICKNESS	WEIGHT
			A	B	C	D		
LDH-08-I	8 1/8 x 13 3/4	206X349	8 1/8 206	13 3/4 349	10 5/8 270	16 1/4 413	1/2 12	4.7KG
LDH-10-I	10 x 10	254X354	10 254	10 254	12 1/2 318	12 1/2 318	1/2 12	4.4KG
LDH-20-I	12 1/2 x 17 1/2	318X444	12 1/2 318	17 1/2 444	15 382	20 508	1/2 12	7.1KG
LDH-30-I	14 1/2 x 19 1/2	369X495	14 1/2 369	19 1/2 495	17 433	22 559	1/2 12	8.1KG
LDH-40-I	16 1/2 x 16 1/2	419X419	16 1/2 419	16 1/2 419	19 483	19 483	1/2 12	7.9KG
LDH-50-I	19 1/2 x 19 1/2	495X495	19 1/2 495	19 1/2 495	22 559	22 559	1/2 12	10.0KG
LDH-60-I	24 x 24	610X610	24 610	24 610	26 1/2 674	26 1/2 674	1/2 12	13.0KG
LDH-70-I	31 x 31	788X788	31 788	31 788	33 1/2 852	33 1/2 852	1/2 12	19.2KG

IN/MM

IN/OUTSIDE OPENING

PART No.	SIZE		CUTOUT SIZE		OVERALL		ACRYLIC THICKNESS	WEIGHT
			A	B	C	D		
LDH-30-O	14 1/2 x 19 1/2	369X495	14 1/2 369	19 1/2 495	17 433	22 559	1/2 12	8.3KG
LDH-40-O	16 1/2 x 16 1/2	419X419	16 1/2 419	16 1/2 419	19 483	19 483	1/2 12	8.1KG
LDH-50-O	19 1/2 x 19 1/2	495X495	19 1/2 495	19 1/2 495	22 559	22 559	1/2 12	10.2KG
LDH-60-O	24 x 24	610X610	24 610	24 610	26 1/2 674	26 1/2 674	1/2 12	13.2KG
LDH-70-O	31 x 31	788X788	31 788	31 788	33 1/2 852	33 1/2 852	1/2 12	19.6KG

*Please indicate inside locking or outside locking or w/o outside locker while ordering.

IN/MM

DOUBLE OPENING

PART No.	SIZE		CUTOUT SIZE		OVERALL		ACRYLIC THICKNESS	WEIGHT
			A	B	C	D		
LDH-50-D	19 1/2 x 19 1/2	495X495	19 1/2 495	19 1/2 495	22 559	22 559	1/2 12	10.8KG
LDH-60-D	24 x 24	610X610	24 610	24 610	26 1/2 674	26 1/2 674	1/2 12	14.3KG
LDH-70-D	31 x 31	788X788	31 788	31 788	33 1/2 852	33 1/2 852	1/2 12	20.4KG

IN/MM

DECK HATCH



FEATURES

- **CE Approved. According to ISO/DIS 12216**
Deck Hatches are approved for Area II, III, and IV, designs for craft type "any".

- 316 stainless steel frames, hatch, hatch arms and hinges. Hand polished and electro-polished to protect against corrosion. Frames and hatches are made from machine rolled stock to ensure strength and low weight.
- Positive easy to operate stainless arms allowing full 180 degree opening with pull-turn knobs to hold hatch open.
- Adjustable injection molded Nylon 66 handles.
- Set screw adjustment in each hinge to adjust the proper pressure against the gasket.
- Tough, UV resistance of acrylics are available in grey (standard), clear and tint green.
- Inside opening, inside/outside opening and double opening available.
- Inside/outside models with 100% Stainless Steel snag free handle.
- Double opening models with quick snap-release dogs and 100% stainless fast pins for easy and quick change of hinge location.
- Gaskets are oil resistant Sanplane.
- Custom Deck Hatches are available.
- Off-white powder coating are available.



Luxury deck hatch with gas arm just opened to 90 degree



Stainless arm fasten easily

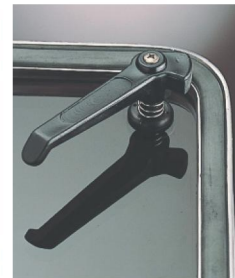

Adjustable handle to ensure tightness

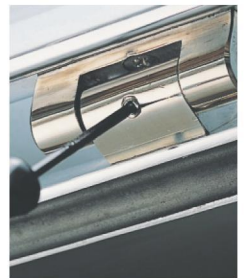

Set screw adjustable in hinge for tightness

INSIDE OPENING



IN/OUTSIDE OPENING



DOUBLE OPENING



ROUND DECK HATCH INSIDE OPENING

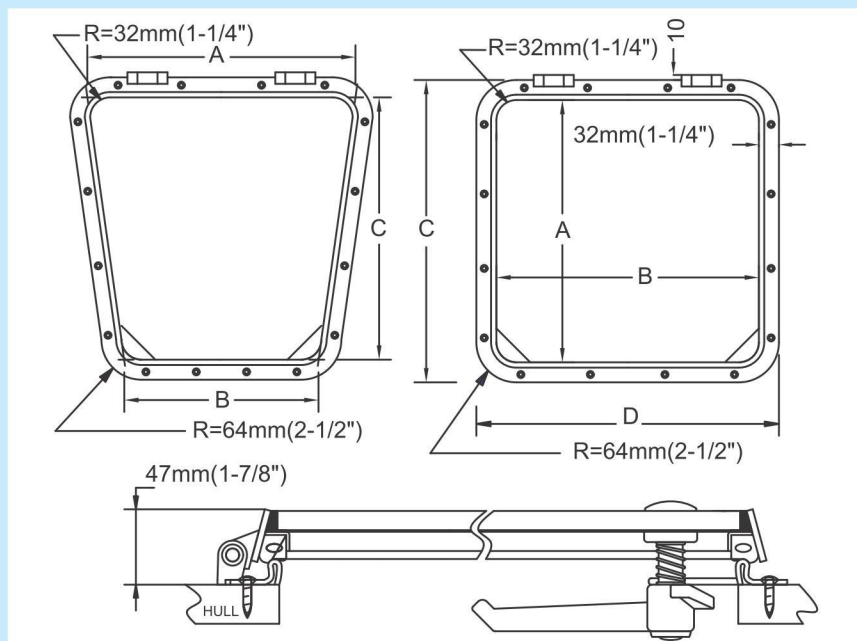

- ANY SIZE ARE AVAILABLE, IF R=1 1/4" (32MM) REMAIN UNCHANGED
- HATCHES SHOULD BE FITTED TO A FLAT SURFACE WITH A MAXIMUM TOLERANCE OF ±2MM.

INSIDE OPENING

PART No.	SIZE	CUTOUT SIZE		OVERALL		ACRYLIC THICKNESS	WEIGHT	
		A	B	C	D			
DH-08-I	8 1/8 X 13 3/4	206X349	8 1/8 206	13 3/4 349	10 5/8 270	16 1/4 413	5/16 8	4.4KG
DH-10-I	10 X 10	254X254	10 254	10 254	12 1/2 318	12 1/2 318	5/16 8	4.1KG
DH-20-I	12 1/2 X 17 1/2	318X444	12 1/2 318	17 1/2 444	15 382	20 508	1/2 12	7.6KG
DH-30-I	14 1/2 X 19 1/2	369X495	14 1/2 369	19 1/2 495	17 433	22 559	1/2 12	9.0KG
DH-40-I	16 1/2 X 16 1/2	419X419	16 1/2 419	16 1/2 419	19 483	19 483	1/2 12	8.6KG
DH-50-I	19 1/2 X 19 1/2	495X495	19 1/2 495	19 1/2 495	22 559	22 559	1/2 12	10.8KG
DH-60-I	24 X 24	610X610	24 610	24 610	26 1/2 674	26 1/2 674	1/2 12	13.8KG
DH-70-I	31 X 31	788X788	31 788	31 788	33 1/2 852	33 1/2 852	1/2 12	19.8KG

IN/MM

IN/OUTSIDE OPENING

PART No.	SIZE	CUTOUT SIZE		OVERALL		ACRYLIC THICKNESS	WEIGHT	
		A	B	C	D			
DH-30-O	14 1/2 X 19 1/2	369X495	14 1/2 369	19 1/2 495	17 433	22 559	1/2 12	9.2KG
DH-40-O	16 1/2 X 16 1/2	419X419	16 1/2 419	16 1/2 419	19 483	19 483	1/2 12	8.8KG
DH-50-O	19 1/2 X 19 1/2	495X495	19 1/2 495	19 1/2 495	22 559	22 559	1/2 12	11KG
DH-60-O	24 X 24	610X610	24 610	24 610	26 1/2 674	26 1/2 674	1/2 12	14KG
DH-70-O	31 X 31	788X788	31 788	31 788	33 1/2 852	33 1/2 852	1/2 12	20KG

*Please indicate inside locking or outside locking or w/o outside locker while ordering.

IN/MM

DOUBLE OPENING

PART No.	SIZE	CUTOUT SIZE		OVERALL		ACRYLIC THICKNESS	WEIGHT	
		A	B	C	D			
DH-50-D	19 1/2 X 19 1/2	495X495	19 1/2 495	19 1/2 495	22 559	22 559	1/2 12	12KG
DH-60-D	24 X 24	610X610	24 610	24 610	26 1/2 674	26 1/2 674	1/2 12	15KG
DH-70-D	31 X 31	788X788	31 788	31 788	33 1/2 852	33 1/2 852	1/2 12	21KG

IN/MM

ROUND DECK HATCH INSIDE OPENING

PART No.	SIZE	CUTOUT SIZE		OVERALL C	ACRYLIC THICKNESS	WEIGHT
		A	B			
DHR-50-I	19 1/2 495	19 1/2 495	19 1/2 495	22 559	1/2 12	9KG
DHR-60-I	24 610	24 610	24 610	26 1/2 674	1/2 12	11.9KG

IN/MM



FRICATIVE HINGE FLUSH HATCH

Manship developed new design and got the patent in Italy, China and Taiwan. Stainless steel fricative hinge is installed in flush hatch. Hatch base and assembly are in stainless steel 316 material. Mirror polishing surface can be used in badly marine. The appearance of hatch is strong and elegant.



Star-shaped handle is available for inside/outside opening.

FEATURES

- Optional powder coating colors for stainless steel 316 hatch base
- Tempered acrylic 10mm with UV resistance and colors optional
- Stainless steel fricative hinge patented, hatch arm no need, can enlarge the exit space
- Optional inside and inside/outside opening handles for hatches
- Sanplane gasket with 100% watertight installed in hatches

Manship provides the hatches in standard sizes and custom flush hatches are also available (cutout size can't over $24\frac{1}{16} \times 24\frac{1}{16}$ 627*627).

INSIDE OPENING



IN/OUTSIDE OPENING

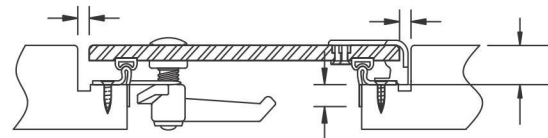
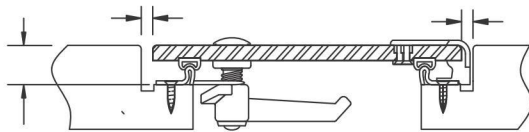
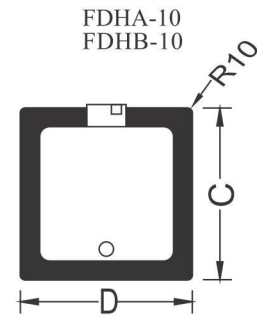
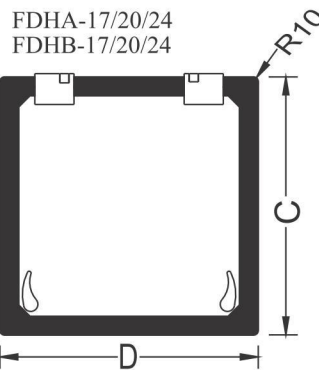
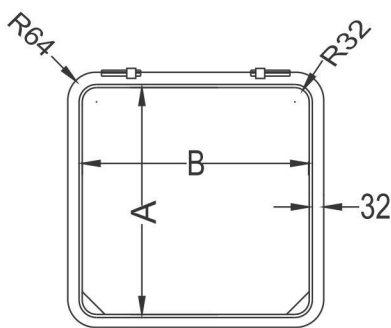

INSIDE OPENING

PART No.	FDHA CUTOUT SIZE		FDHB CUTOUT SIZE		OVERALL		ACRYLIC THICKNESS	WEIGHT (Kg)
	A	B	A	B	C	D		
31 ± 1 FDHA-10-I FDHB-10-I (NO SPIGOT)	$10\frac{1}{4} \times 10\frac{1}{4}$	260×260 (WITH SPIGOT)	$10\frac{5}{64} \times 10\frac{5}{64}$	256×256	13×13	330×330	$\frac{1}{2}$ 12	4.7
FRP FDHA-17-I FDHB-17-I	$17\frac{3}{8} \times 17\frac{3}{8}$	442×442	$17\frac{1}{4} \times 17\frac{1}{4}$	438×438	$20\frac{3}{16} \times 20\frac{3}{16}$	512×512	$\frac{1}{2}$ 12	7.6
FRP FDHA-20-I FDHB-20-I	$19\frac{15}{16} \times 19\frac{15}{16}$	507×507	$19\frac{13}{16} \times 19\frac{13}{16}$	503×503	$22\frac{11}{16} \times 22\frac{11}{16}$	577×577	$\frac{5}{8}$ 15	9.2
FRP FDHA-24-I FDHB-24-I	$24\frac{11}{16} \times 24\frac{11}{16}$	627×627	$24\frac{9}{16} \times 24\frac{9}{16}$	624×624	$27\frac{1}{2} \times 27\frac{1}{2}$	697×697	$\frac{5}{8}$ 15	12.4 $\frac{IN}{MM}$

IN/OUTSIDE OPENING

PART No.	FDHA CUTOUT SIZE		FDHB CUTOUT SIZE		OVERALL		ACRYLIC THICKNESS	WEIGHT (Kg)
	A	B	A	B	C	D		
FRP FDHA-10-O FDHB-10-O	$10\frac{1}{4} \times 10\frac{1}{4}$	260×260	$10\frac{5}{64} \times 10\frac{5}{64}$	256×256	13×13	330×330	$\frac{1}{2}$ 12	4.7
FRP FDHA-17-O FDHB-17-O	$17\frac{3}{8} \times 17\frac{3}{8}$	442×442	$17\frac{1}{4} \times 17\frac{1}{4}$	438×438	$20\frac{3}{16} \times 20\frac{3}{16}$	512×512	$\frac{1}{2}$ 12	7.6
FRP FDHA-20-O FDHB-20-O	$19\frac{15}{16} \times 19\frac{15}{16}$	507×507	$19\frac{13}{16} \times 19\frac{13}{16}$	503×503	$22\frac{11}{16} \times 22\frac{11}{16}$	577×577	$\frac{5}{8}$ 15	9.2
FRP FDHA-24-O FDHB-24-O	$24\frac{11}{16} \times 24\frac{11}{16}$	627×627	$24\frac{9}{16} \times 24\frac{9}{16}$	623×623	$27\frac{1}{2} \times 27\frac{1}{2}$	697×697	$\frac{5}{8}$ 15	12.4 $\frac{IN}{MM}$



HATCH SKYSCREEN

- Hatch skyscreen used the fabrics for waterproof, and 80% heat reflection. It also designed for solar shield and mosquito-repellent.
- Hatch skyscreen composed by Aluminum 6061T5. Hatch skyscreen used roller function to proceed solar shield and mosquito-repellent skyscreen with pull off/back motion.
- The dimension followed Manship standard fricative hinge hatch, low profile deck hatch, deck and special dimension hatch.

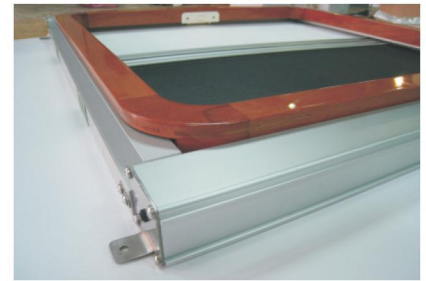

**Elegant wooden flange
(color available)**



Pull off/back motion button

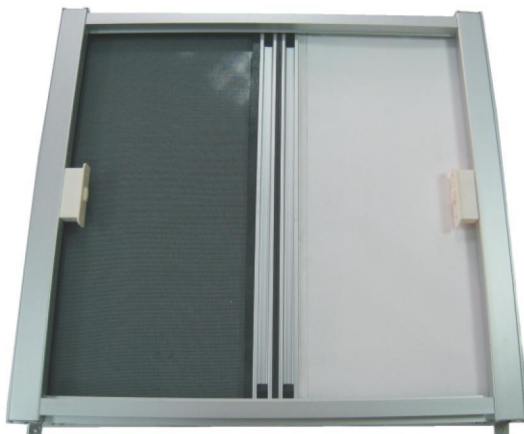

Hatch sky screen body

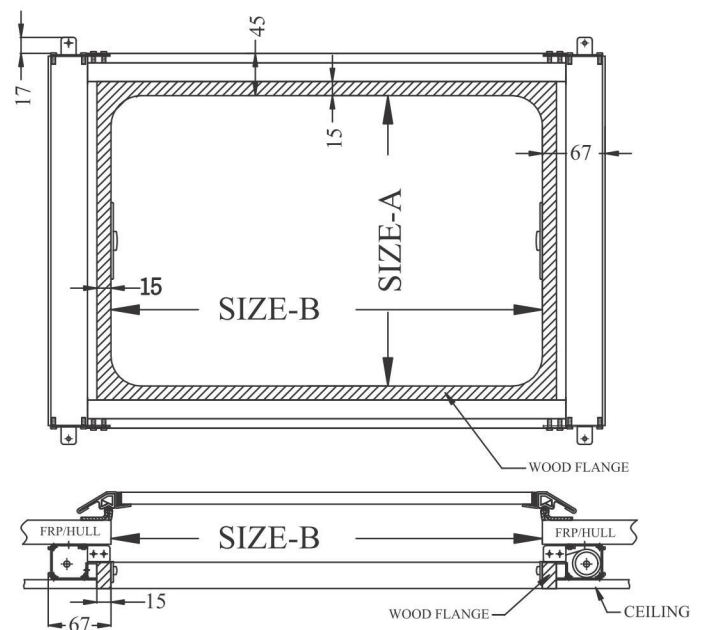

WELCOME TO MANSHIP PORTLIGHT WORLD



set screw to be adjusted for water tightness.

LS, LSO, LSR, LO, LE, LR(Model No.0512-0818)adopt Anti-UV, Anti-rubbing. Polycarbonate sheet clear 8mm without storm cover that meet with CE approval. Then its part no. will become PLS, PLSO, PLSR, PLO, PLE, PLR for ordering. According to ISO/DIS 12216 for Area I II III IV designs for craft type "any".

- **CE Approved. According to ISO/DIS 12216**
LS, LSO, LSR type are approved for Area III, IV, designs for craft type "any".
CLS, CLSO, CLSR type approved for Area I, II, III, and IV, designs for craft type "any".

- 316 stainless steel machined rolled frames hand polished and electro polished to provide long lasting protection against corrosion.
- Cast 316 stainless steel hinges with set screw to adjust gasket pressure.
- Weather resistant thermo-plastic Sanplane gasket.
- High Strength tempered clear glass.
- Optional fiberglass screens with rubber gaskets to ensure a tight fit on the inside of the opening port.
- Straight or angled spigots available.
- Off-white powder coating available.
- Standard ports are with plastic black knob as closing handle. This handle can be changed into s/s ring.
- Fixed or removable storm cover available.



Model No.0512 ~ 0818

Model No.1020 ~ 1228

Glass colors available

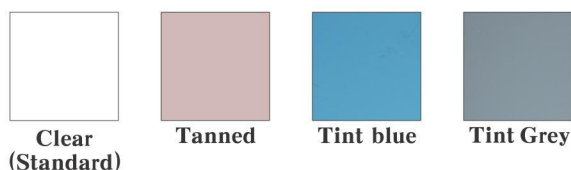

Additional "STAY" can be added, if you like.

CxD-CUTOUT SIZE

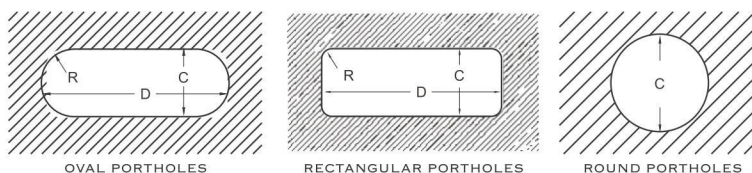



HOW TO FIX THE PORTLIGHT

- It can fit in LS, LSO, LSR, CLS, CLSO, CLSR, FLS, FLSO, &FLSR.
- LS-H, CLS-H, LSO-H,CLSO-H, CSR-H, CLSR-H MUST ADOPT ASM-005 FIXING

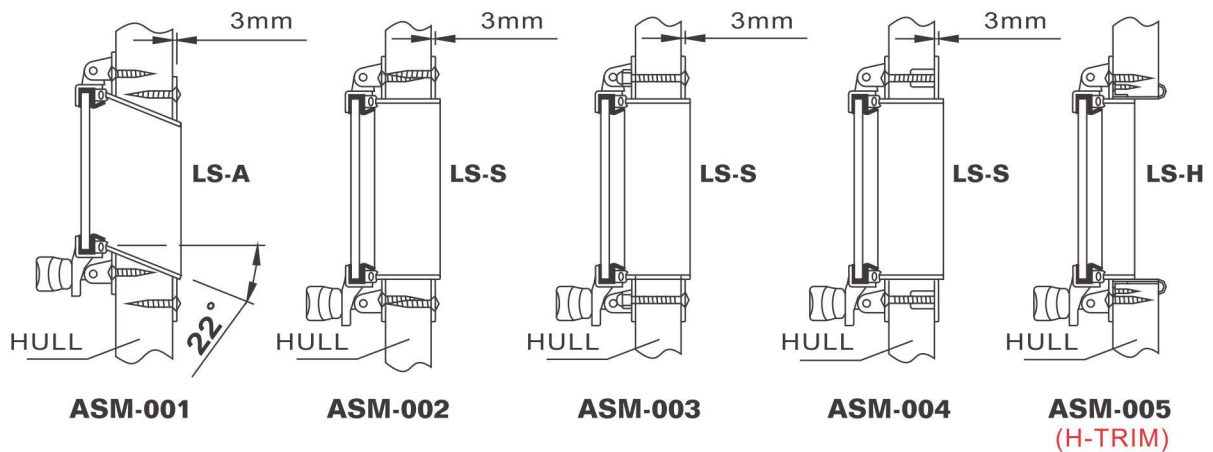

※To order Man ship ports, pls take note the below.

- 1.All the models in catalog are standard. Pls advise model no, and spigot G when ordering.
- 2.If the ports with custom sizes, then its cut out size & spigot G are needed.
- 3.Optional items, pls mark it while ordering.
 - A.Fixing way:ASM-003, ASM-004(Standard fixing:ASM-001 & ASM-002)
 - B.Colored glass:tanned, tint blue, tint green(Standard glass:clear)
 - C.Parts-(a)Stainless steel ring dog(b)Stay(c)Screen
 - D.Powder coating(off-white/pure white/black)or Titanium plated(Golden color)

OPTIONAL PARTS (for ports)

Pls inform the size A x B of ports while ordering. We will offer suitable parts to your need.



(a) Stainless steel ring dog.

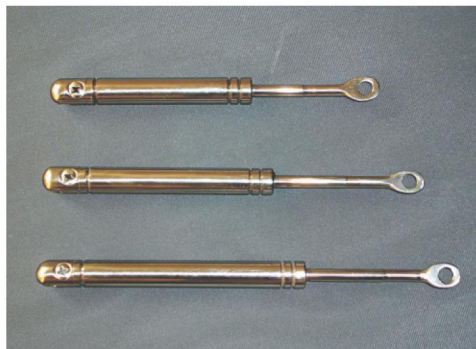

(b) "Stay" can be opened at any degree.
If order Stay, pls must advise the dimensions of ports.



(c) Screen



FRICATIVE HINGE PORTS

(If you would like to order the modern portlight, please noted "hinge" in the order.)

FRICATIVE HINGE PATENT IN MANY COUNTRIES



If you order the portlight with fricative hinge, No need to install stay or port hook on the portlight.

- New patent design:unique SS 316 fricative hinge.
- New portlight can be opened at any degree,especially can be opened at 180 degree without arm or port hook to support. It is elegant.
- Storm cover easily installed and removed.It also can be adjusted for gasket water tightness.

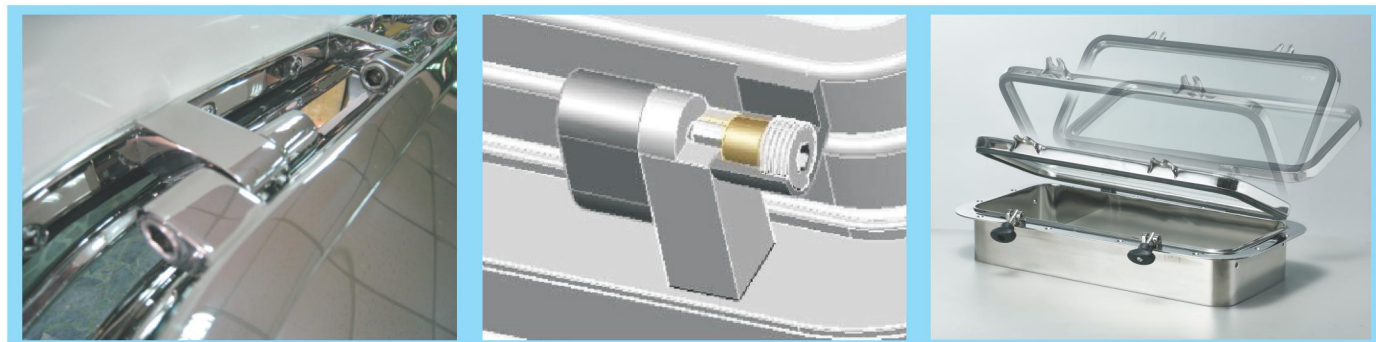

Fricative hinge structure(china patented)

Modern portlighty can be applied in the following model and dimension.

- Opening ports: LS,LSO,LSR,CLS,CLSO,CLSR
TLS,TLSO,TLRS,CTLS,CTLISO,CTLSR
LS-H,LSO-H,LSR-H,CLS-H,CLSO-H
CLSR-H,LO,CLO
- Dimension:Small portlight Model Number 0512-088
Big portlight Model Number 1020-1228
Special dimension:If there is no portlight models size in the catalogue,
Please inform the Model No, the dimension and spigot.

RECTANGULAR OPENING PORTS

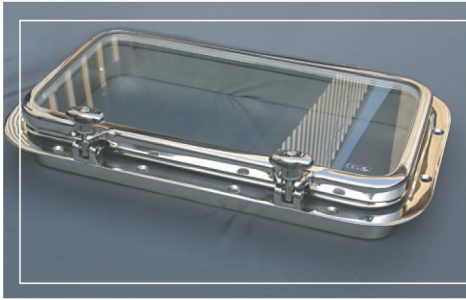

Rectangular opening ports



LS Rect. Portholes / boat outside view



Rect port with storm cover.

RECTANGULAR OPENING PORTS - ANGLED SPIGOT

MODEL No.	A x B		C x D		E x F		R	R1	GLASS THICKNESS	
	W/O COVER	W/COVER	MODEL	CUT OUT SIZE	OVERALL	OVERALL				
LS-0512A	5X12	127X305	5 1/4 X 12 1/8	133x307	7 5/8 X 14 1/2	193x368	1 1/4 32	2 3/8 62	1/4 6	
LS-0714A	7X14	178X356	7 1/4 X 14 1/4	184x362	9 5/8 X 16 5/8	244x422	1 1/4 32	2 3/8 62	1/4 6	
LS-0716A	CLS-0716A	7X16	178X406	7 1/4 X 16 1/4	184x413	9 5/8 X 18 5/8	244x473	1 1/4 32	2 3/8 62	1/4 6
LS-0718A	CLS-0718A	7X18	178X457	7 1/4 X 18 1/4	184x464	9 5/8 X 20 5/8	244x524	1 1/4 32	2 3/8 62	1/4 6
LS-0816A	CLS-0816A	8X16	203X406	8 1/4 X 16 1/4	210x413	10 5/8 X 18 5/8	269x473	1 1/4 32	2 3/8 62	1/4 6
LS-0818A	CLS-0818A	8X18	203X457	8 1/4 X 18 1/4	210x464	10 5/8 X 20 5/8	269x524	1 1/4 32	2 3/8 62	1/4 6
LS-1020A	CLS-1020A	10X20	254X508	10 3/8 X 20 3/8	262x516	12 7/8 X 22 7/8	327x581	1 1/4 32	2 1/2 65	3/8 10
LS-1024A	CLS-1024A	10X24	254X609	10 3/8 X 24 3/8	262x617	12 7/8 X 26 7/8	327x682	1 1/4 32	2 1/2 65	3/8 10
LS-1224A	CLS-1224A	12X24	305X609	12 3/8 X 24 3/8	313x617	14 7/8 X 26 7/8	378x682	1 1/4 32	2 1/2 65	3/8 10
LS-1228A	CLS-1228A	12X28	305X710	12 3/8 X 28 3/8	313x718	14 7/8 X 30 7/8	378x784	1 1/4 32	2 1/2 65	3/8 10

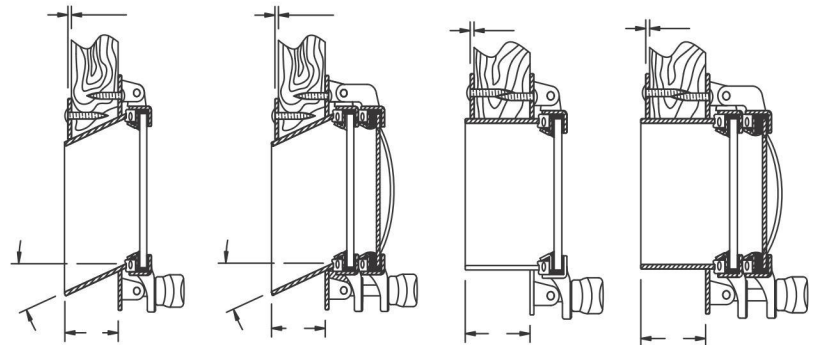
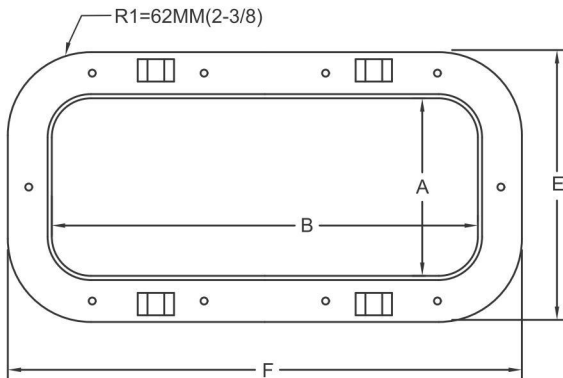

RECTANGULAR OPENING PORTS - STRAIGHT SPIGOT

MODEL No.	A x B		C x D		E x F		R	R1	GLASS THICKNESS	
	W/O COVER	W/COVER	MODEL	CUT OUT SIZE	OVERALL	OVERALL				
LS-0512S	5X12	127X305	5 1/4 X 12 1/8	133x307	7 5/8 X 14 1/2	193x368	1 1/4 32	2 3/8 62	1/4 6	
LS-0714S	7X14	178X356	7 1/4 X 14 1/4	184x362	9 5/8 X 16 5/8	244x422	1 1/4 32	2 3/8 62	1/4 6	
LS-0716S	CLS-0716S	7X16	178X406	7 1/4 X 16 1/4	184x413	9 5/8 X 18 5/8	244x473	1 1/4 32	2 3/8 62	1/4 6
LS-0718S	CLS-0718S	7X18	178X457	7 1/4 X 18 1/4	184x464	9 5/8 X 20 5/8	244x524	1 1/4 32	2 3/8 62	1/4 6
LS-0816S	CLS-0816S	8X16	203X406	8 1/4 X 16 1/4	210x413	10 5/8 X 18 5/8	269x473	1 1/4 32	2 3/8 62	1/4 6
LS-0818S	CLS-0818S	8X18	203X457	8 1/4 X 18 1/4	210x464	10 5/8 X 20 5/8	269x524	1 1/4 32	2 3/8 62	1/4 6
LS-1020S	CLS-1020S	10X20	254X508	10 3/8 X 20 3/8	262x516	12 7/8 X 22 7/8	327x581	1 1/4 32	2 1/2 65	3/8 10
LS-1024S	CLS-1024S	10X24	254X609	10 3/8 X 24 3/8	262x617	12 7/8 X 26 7/8	327x682	1 1/4 32	2 1/2 65	3/8 10
LS-1224S	CLS-1224S	12X24	305X609	12 3/8 X 24 3/8	313x617	14 7/8 X 26 7/8	378x682	1 1/4 32	2 1/2 65	3/8 10
LS-1228S	CLS-1228S	12X28	305X710	12 3/8 X 28 3/8	313x718	14 7/8 X 30 7/8	378x784	1 1/4 32	2 1/2 65	3/8 10

- Standard angled spigot size "G" available 1 1/4" 32mm · 1 1/2" 38mm · 2" 51mm · 2 1/2" 63mm · 3" 76mm · 3 1/2" 89mm
- Special spigot size "G" available from 1" 25.4mm ~ 5" 127mm
- Custom sizes available if Radius (R & R1) are kept unchanged.
- The spigot height are needed, while ordering.
- CLS-0716~CLS-1228 are with elegant arc storm cover.

IN/MM

OVAL OPENING PORTHOLES



Oval opening portholes.



LSO Oval portholes / boat outside view



Oval opening portlight with storm cover.

OVAL OPENING PORTS - ANGLED SPIGOT

MODEL No.		A x B		C x D		E x F		R	R1	GLASS THICKNESS
W/O COVER	W/COVER	MODEL		CUT OUT SIZE		OVERALL				
LSO-0512A		5X12	127X305	5 1/4 X 12 1/8	133x307	7 5/8 X 14 1/2	193x368	2 5/8 67	3 7/8 98	5/16 8
LSO-0714A		7X14	178X356	7 1/4 X 14 1/4	184x362	9 5/8 X 16 5/8	244x422	3 5/8 92	4 7/8 124	5/16 8
LSO-0716A	CLSO-0716A	7X16	178X406	7 1/4 X 16 1/4	184x413	9 5/8 X 18 5/8	244x473	3 5/8 92	4 7/8 124	5/16 8
LSO-0718A	CLSO-0718A	7X18	178X457	7 1/4 X 18 1/4	184x464	9 5/8 X 20 5/8	244x524	3 5/8 92	4 7/8 124	5/16 8
LSO-0816A	CLSO-0816A	8X16	203X406	8 1/4 X 16 1/4	210x413	10 5/8 X 18 5/8	269x473	4 1/8 104	5 3/8 137	5/16 8
LSO-0818A	CLSO-0818A	8X18	203X457	8 1/4 X 18 1/4	210x464	10 5/8 X 20 5/8	269x524	4 1/8 104	5 3/8 137	5/16 8
LSO-1020A	CLSO-1020A	10X20	254X508	10 3/8 X 20 3/8	262x516	12 7/8 X 22 7/8	327x581	5 1/8 131	6 3/8 164	3/8 10
LSO-1024A	CLSO-1024A	10X24	254X609	10 3/8 X 24 3/8	262x617	12 7/8 X 26 7/8	327x682	5 1/8 131	6 3/8 164	3/8 10
LSO-1224A	CLSO-1224A	12X24	305X609	12 3/8 X 24 3/8	313x617	14 7/8 X 26 7/8	378x682	6 1/8 157	7 3/8 190	3/8 10
LSO-1228A	CLSO-1228A	12X28	305X710	12 3/8 X 28 3/8	313x718	14 7/8 X 30 7/8	378x784	6 1/8 157	7 3/8 190	3/8 10

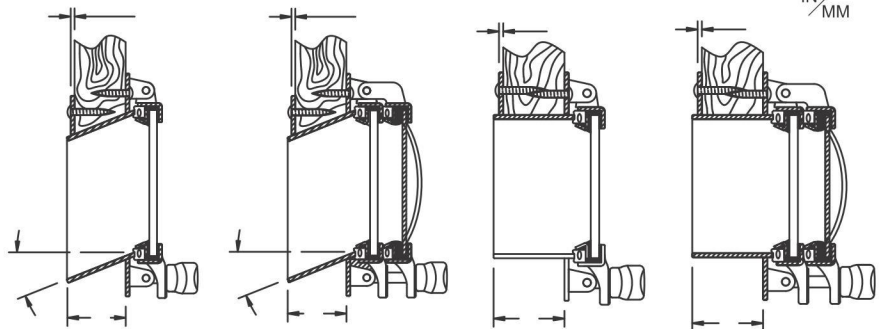
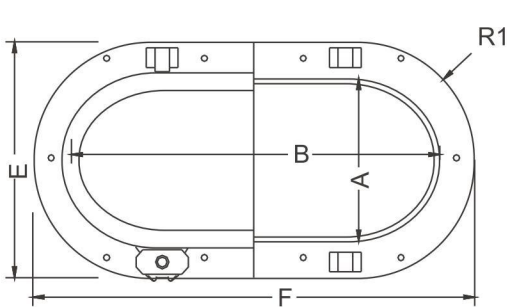

LSO-XXXXA

CLSO-XXXXA

LSO-XXXXS

CLSO-XXXXS

OVAL OPENING PORTS - STRAIGHT SPIGOT

MODEL No.		A x B		C x D		E x F		R	R1	GLASS THICKNESS
W/O COVER	W/COVER	MODEL		CUT OUT SIZE		OVERALL				
LSO-0512S		5X12	127X305	5 1/4 X 12 1/8	133x307	7 5/8 X 14 1/2	193x368	2 5/8 67	3 7/8 98	5/16 8
LSO-0714S		7X14	178X356	7 1/4 X 14 1/4	184x362	9 5/8 X 16 5/8	244x422	3 5/8 92	4 7/8 124	5/16 8
LSO-0716S	CLSO-0716S	7X16	178X406	7 1/4 X 16 1/4	184x413	9 5/8 X 18 5/8	244x473	3 5/8 92	4 7/8 124	5/16 8
LSO-0718S	CLSO-0718S	7X18	178X457	7 1/4 X 18 1/4	184x464	9 5/8 X 20 5/8	244x524	3 5/8 92	4 7/8 124	5/16 8
LSO-0816S	CLSO-0816S	8X16	203X406	8 1/4 X 16 1/4	210x413	10 5/8 X 18 5/8	269x473	4 1/8 104	5 3/8 137	5/16 8
LSO-0818S	CLSO-0818S	8X18	203X457	8 1/4 X 18 1/4	210x464	10 5/8 X 20 5/8	269x524	4 1/8 104	5 3/8 137	5/16 8
LSO-1020S	CLSO-1020S	10X20	254X508	10 3/8 X 20 3/8	262x516	12 7/8 X 22 7/8	327x581	5 1/8 131	6 3/8 164	3/8 10
LSO-1024S	CLSO-1024S	10X24	254X609	10 3/8 X 24 3/8	262x617	12 7/8 X 26 7/8	327x682	5 1/8 131	6 3/8 164	3/8 10
LSO-1224S	CLSO-1224S	12X24	305X609	12 3/8 X 24 3/8	313x617	14 7/8 X 26 7/8	378x682	6 1/8 157	7 3/8 190	3/8 10
LSO-1228S	CLSO-1228S	12X28	305X710	12 3/8 X 28 3/8	313x718	14 7/8 X 30 7/8	378x784	6 1/8 157	7 3/8 190	3/8 10

- Standard angled spigot size "G" available 1 1/4" 32mm · 1 1/2" 38mm · 2" 51mm · 2 1/2" 63mm · 3 7/8" 89mm
- Special spigot size "G" available from 1" 25.4mm ~ 5" 127mm
- Custom sizes available if Radius (R & R1) are kept unchanged.
- The spigot height are needed, while ordering.
- CLS-0716~CLS-1228 are with elegant arc storm cover.

ROUND OPENING PORTHOLES



Round opening ports



LSR Round Portholes / boat outside view



Round ports with storm cover

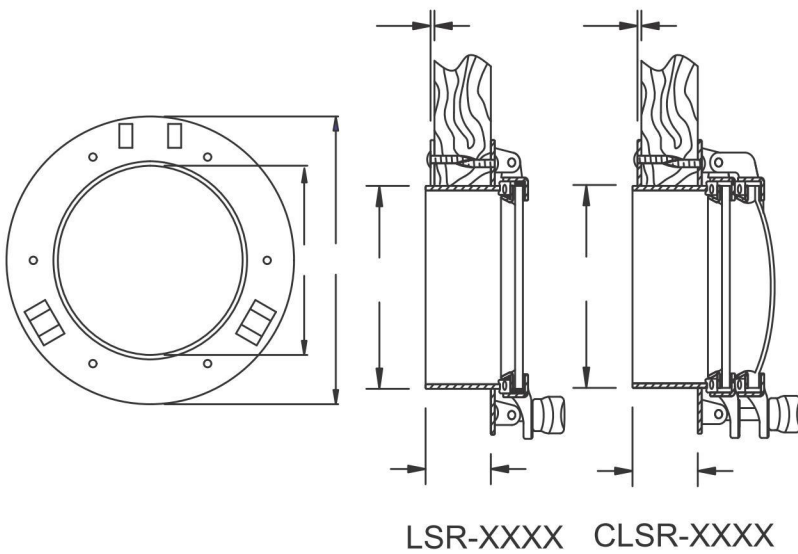

PORT HOOK

MODEL No.	MODEL		C		E		GLASS THICKNESS	
	W/O COVER	W/COVER	CUT OUT SIZE	CUT OUT SIZE	OVERALL	OVERALL		
LSR-0700	7	178	7 $\frac{1}{4}$	184	9 $\frac{5}{8}$	244	$\frac{5}{16}$ 8	
LSR-0800	8	203	8 $\frac{1}{4}$	210	10 $\frac{5}{8}$	269	$\frac{5}{16}$ 8	
LSR-1000	CLSR-1000	10	254	10 $\frac{3}{8}$	262	12 $\frac{7}{8}$	327	$\frac{3}{8}$ 10
LSR-1200	CLSR-1200	12	305	12 $\frac{3}{8}$	311	14 $\frac{7}{8}$	378	$\frac{3}{8}$ 10
LSR-1400	CLSR-1400	14	356	14 $\frac{3}{8}$	365	16 $\frac{7}{8}$	431	$\frac{3}{8}$ 10

IN/MM

1. Standard spigot size "G" available 1 $\frac{1}{4}$ " · 1 $\frac{1}{2}$ " · 2" · 2 $\frac{1}{2}$ " · 3" · 3 $\frac{1}{2}$ "
2. Special spigot size "G" available from 1"~5"
3. The spigot height are needed, while ordering.
4. CLSR-0700~CLSR-1400 are with elegant arc storm cover.

PORT HOOK

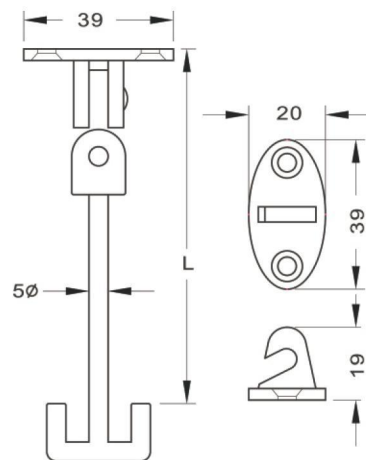

Standard size (L): 3", 4", 5", 6" & custom size available.

HEAVY DUTY PORTS

Suitable for steel boat and Aluminum boat.

• CE Approved. According to ISO / DIS 12216

TLS, TLSO, TLSR type are applied to Area III, IV. Designs for craft type "any".

CTLS, CTLSO, CTLSR type are applied to Area I, II, III, IV. Designs for craft type "any".

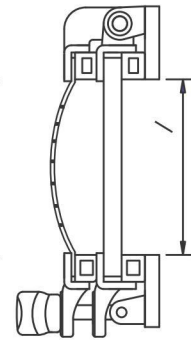
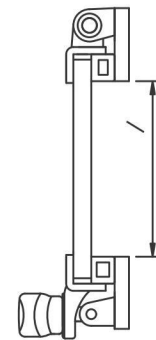
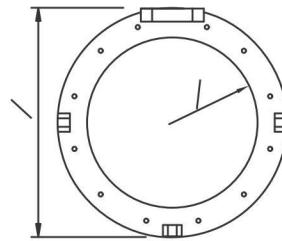

TLSR-XXXX

CTLSR-XXXX

MODEL No.		A x B		C x D		E x F		GLASS THICKNESS	
W/O COVER	W/COVER	MODEL	MODEL	CUT OUT SIZE		OVERALL			
TLSR-1000	CTLSR-1000	10	254	10	254	13 5/16	338	3/8	10
TLSR-1200	CTLSR-1200	12	305	12	305	15 5/16	389	3/8	10
TLSR-1400	CTLSR-1400	14	356	14	356	17 5/16	440	3/8	10

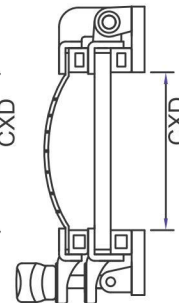
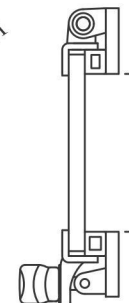
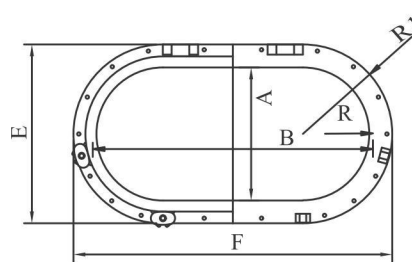

TSO-XXXX

CTSO-XXXX

MODEL No.		A x B		C x D		E x F		R	R1	GLASS THICKNESS
W/O COVER	W/COVER	MODEL	MODEL	CUT OUT SIZE		OVERALL				
TLSO-1020	CTLSO-1020	10X20	254X508	10X20	254X508	13 5/16 X 23 5/16	338x592	5 127	6 5/8 169	3/8 10
TLSO-1024	CTLSO-1024	10X24	254X609	10X24	254X609	13 5/16 X 27 5/16	338x694	5 127	6 5/8 169	3/8 10
TLSO-1224	CTLSO-1224	12X24	305X609	12X24	305X609	15 5/16 X 27 5/16	389x694	6 152	7 5/8 194	3/8 10
TLSO-1228	CTLSO-1228	12X28	305X710	12X28	305X710	15 5/16 X 31 5/16	389x795	6 152	7 5/8 194	3/8 10

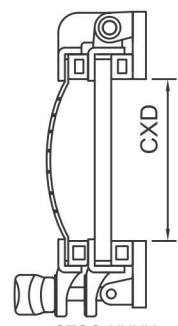
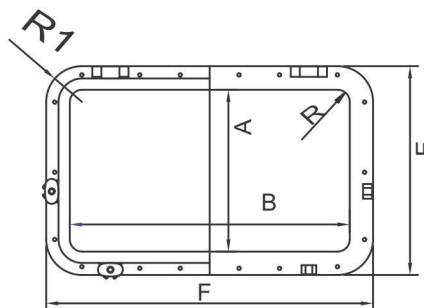

TSO-XXXX

CTSO-XXXX

MODEL No.		A x B		C x D		E x F		R	R1	GLASS THICKNESS
W/O COVER	W/COVER	MODEL	MODEL	CUT OUT SIZE		OVERALL				
TLS-1020	CTLS-1020	10X20	254X508	10X20	254X508	13 5/16 X 23 5/16	338x592	2" 50	3 5/8 92	3/8 10
TLS-1024	CTLS-1024	10X24	254X609	10X24	254X609	13 5/16 X 27 5/16	338x694	2" 50	3 5/8 92	3/8 10
TLS-1224	CTLS-1224	12X24	305X609	12X24	305X609	15 5/16 X 27 5/16	389x694	2" 50	3 5/8 92	3/8 10
TLS-1228	CTLS-1228	12X28	305X710	12X28	305X710	15 5/16 X 31 5/16	389x795	2" 50	3 5/8 92	3/8 10

IN/MM

HEAVY DUTY PORTS (G)

1. Install with heavy duty ports spigot and weld on the hull spigot (G). Stainless Steel (316) and Aluminum (5052) are available.
2. Standard angled spigot size "G" available 1-1/4"(32mm), 1-1/2"(38mm), 2"(51mm), 2-1/2" (63mm), 3"(76mm), 3-1/2(89mm).
3. Special spigot size "G" available form 1" (25.4mm)~6"(152mm).
4. Custom sizes available if Radius (R&R1) are kept unchanged.
5. The spigot height are needed, while ordering.

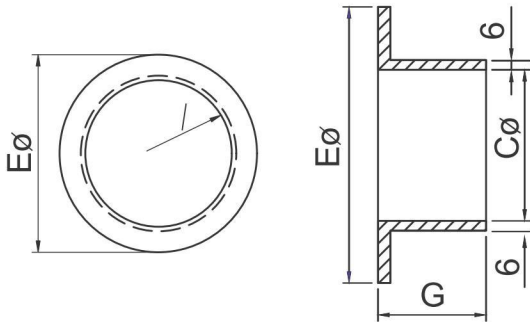

MODEL NO .		A MODEL		E OVER ALL	
TLSR-1000G	CTLSR-1000G	10	254	13-5/16	338
TLSR-1200G	CTLSR-1200G	12	305	15-5/16	389
TLSR-1400G	CTLSR-1400G	14	356	17-5/16	440

IN/MM

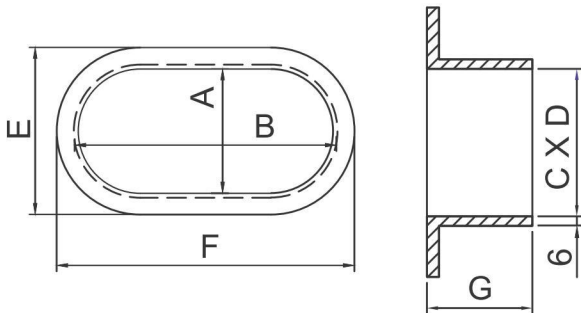

MODEL NO .		A x B MODEL		E x F OVER ALL	
TLSO-1020G	CTLSO-1020G	10X20	254X508	13-5/16X23-5/16	338X592
TLSO-1024G	CTLSO-1024G	10X24	254X609	13-5/16X27-5/16	338X694
TLSO-1224G	CTLSO-1224G	12X24	305X609	15-5/16X27-5/16	389X694
TLSO-1228G	CTLSO-1228G	12X28	305X710	15-5/16X31-5/16	389X795

IN/MM

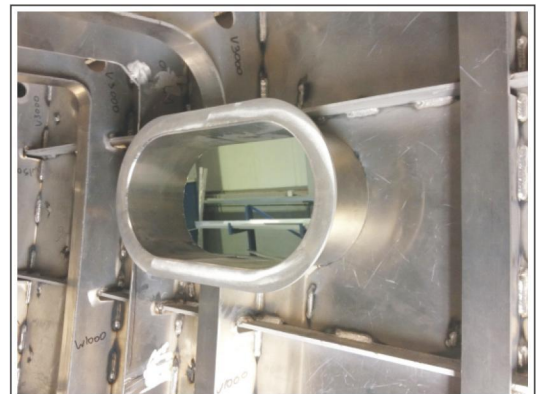
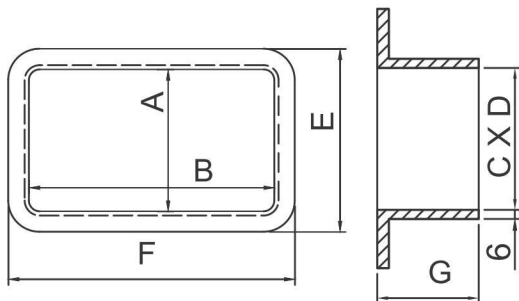

MODEL NO .		A x B MODEL		E x F OVER ALL	
TLS-1020G	CTLS-1020G	10X20	254X508	13-5/16X23-5/16	338X592
TLS-1024G	CTLS-1024G	10X24	254X609	13-5/16X27-5/16	338X694
TLS-1224G	CTLS-1224G	12X24	305X609	15-5/16X27-5/16	389X694
TLS-1228G	CTLS-1228G	12X28	305X710	15-5/16X31-5/16	389X795

OPENING PORTS (H-TRIM)

H-Trim: 316 stainless steel material, the appearance is elegant, not the same as traditional frames.

LS-H



LS-H · CLS-H OPENING PORTHOLE

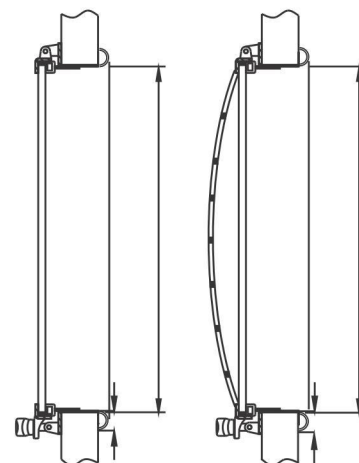
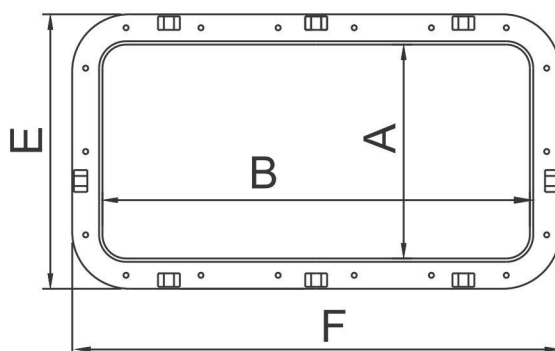

LS-H, CLS-H

MODEL No.		A x B		C x D		E x F		H	R	R1	GLASS THICKNESS
W/O COVER	W/COVER	MODEL	MODEL	CUT OUT SIZE		OVERALL					
LS-0512H		5X12	127X305	5 1/2 X 12 3/8	139X313	7 5/8 X 14 1/2	193x368	5/8 15	1 1/4 32	2 3/8 62	1/4 6
LS-0714H		7X14	178X356	7 1/2 X 14 1/2	190X368	9 5/8 X 16 5/8	244x422	5/8 15	1 1/4 32	2 3/8 62	1/4 6
LS-0716H	CLS-0716H	7X16	178X406	7 1/2 X 16 1/2	190X419	9 5/8 X 18 5/8	244x473	5/8 15	1 1/4 32	2 3/8 62	1/4 6
LS-0718H	CLS-0718H	7X18	178X457	7 1/2 X 18 1/2	190X470	9 5/8 X 20 5/8	244x524	5/8 15	1 1/4 32	2 3/8 62	1/4 6
LS-0816H	CLS-0816H	8X16	203X406	8 1/2 X 16 1/2	216X419	10 5/8 X 18 5/8	269x473	5/8 15	1 1/4 32	2 3/8 62	1/4 6
LS-0818H	CLS-0818H	8X18	203X457	8 1/2 X 18 1/2	216X470	10 5/8 X 20 5/8	269x524	5/8 15	1 1/4 32	2 3/8 62	1/4 6
LS-1020H	CLS-1020H	10X20	254X508	10 5/8 X 20 5/8	268X522	12 7/8 X 22 7/8	327x581	3/4 20	1 1/4 32	2 1/2 65	3/8 10
LS-1024H	CLS-1024H	10X24	254X609	10 5/8 X 24 5/8	268X623	12 7/8 X 26 7/8	327x682	3/4 20	1 1/4 32	2 1/2 65	3/8 10
LS-1224H	CLS-1224H	12X24	305X609	12 5/8 X 24 5/8	319X623	14 7/8 X 26 7/8	378x682	3/4 20	1 1/4 32	2 1/2 65	3/8 10
LS-1228H	CLS-1228H	12X28	305X710	12 5/8 X 28 5/8	319X724	14 7/8 X 30 7/8	378x784	3/4 20	1 1/4 32	2 1/2 65	3/8 10

IN/MM

CLSO-H



LSO-H · CLSO-H OPENING PORTHOLE

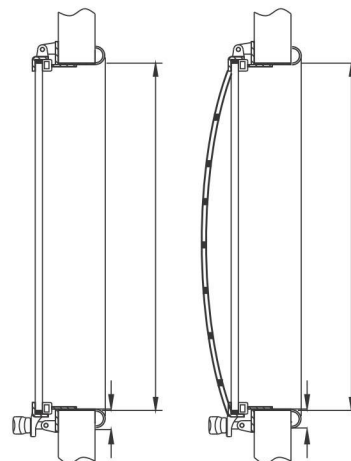
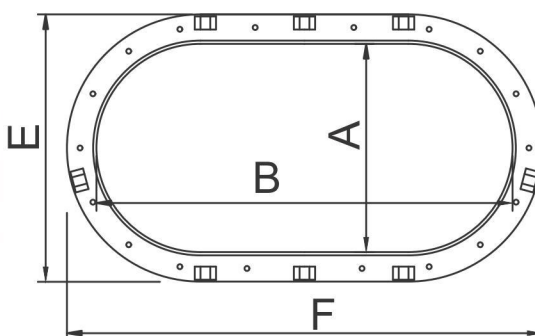

LSO-H, CLSO-H

MODEL No.		A x B		C x D		E x F		H	R	R1	GLASS THICKNESS
W/O COVER	W/COVER	MODEL	MODEL	CUT OUT SIZE		OVERALL					
LSO-0512H		5X12	127X305	5 1/2 X 12 3/8	139X313	7 5/8 X 14 1/2	193x368	5/8 15	1 1/4 32	2 3/8 62	1/4 6
LSO-0714H		7X14	178X356	7 1/2 X 14 1/2	190X368	9 5/8 X 16 5/8	244x422	5/8 15	1 1/4 32	2 3/8 62	1/4 6
LSO-0716H	CLSO-0716H	7X16	178X406	7 1/2 X 16 1/2	190X419	9 5/8 X 18 5/8	244x473	5/8 15	1 1/4 32	2 3/8 62	1/4 6
LSO-0718H	CLSO-0718H	7X18	178X457	7 1/2 X 18 1/2	190X470	9 5/8 X 20 5/8	244x524	5/8 15	1 1/4 32	2 3/8 62	1/4 6
LSO-0816H	CLSO-0816H	8X16	203X406	8 1/2 X 16 1/2	216X419	10 5/8 X 18 5/8	269x473	5/8 15	1 1/4 32	2 3/8 62	1/4 6
LSO-0818H	CLSO-0818H	8X18	203X457	8 1/2 X 18 1/2	216X470	10 5/8 X 20 5/8	269x524	5/8 15	1 1/4 32	2 3/8 62	1/4 6
LSO-1020H	CLSO-1020H	10X20	254X508	10 5/8 X 20 5/8	268X522	12 7/8 X 22 7/8	327x581	3/4 20	1 1/4 32	2 1/2 65	3/8 10
LSO-1024H	CLSO-1024H	10X24	254X609	10 5/8 X 24 5/8	268X623	12 7/8 X 26 7/8	327x682	3/4 20	1 1/4 32	2 1/2 65	3/8 10
LSO-1224H	CLSO-1224H	12X24	305X609	12 5/8 X 24 5/8	319X623	14 7/8 X 26 7/8	378x682	3/4 20	1 1/4 32	2 1/2 65	3/8 10
LSO-1228H	CLSO-1228H	12X28	305X710	12 5/8 X 28 5/8	319X724	14 7/8 X 30 7/8	378x784	3/4 20	1 1/4 32	2 1/2 65	3/8 10

IN/MM

CLSR-H



LSR-H · CLSR-H OPENING PORTHOLE

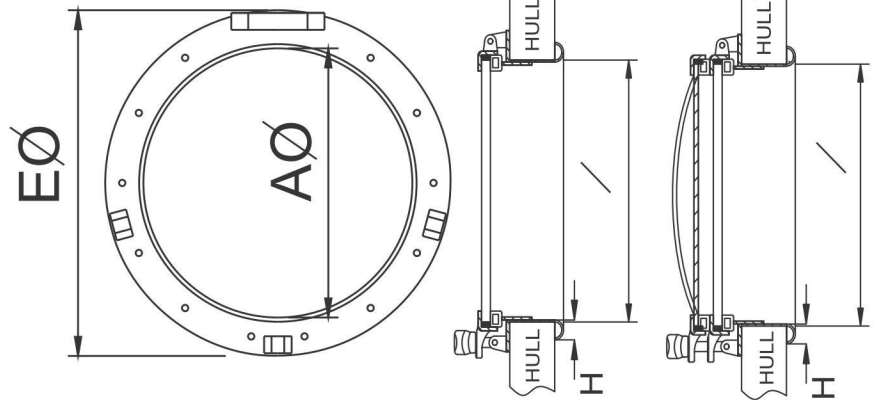

LSR-H, CLSR-H

MODEL No.		A MODEL	C CUT OUT SIZE	E OVERALL	H	GLASS THICKNESS
W/O COVER	W/COVER					
LSR-1000H	CLSR-1000H	10 254	10 1/2 267	12 7/8 327	3/4 20	3/8 10
LSR-1200H	CLSR-1200H	12 305	12 1/2 318	14 7/8 378	3/4 20	3/8 10
LSR-1400H	CLSR-1400H	14 356	14 1/2 368	16 7/8 429	3/4 20	3/8 10

IN/MM

1. Standard angled spigot size "G" available 1 1/4" 32mm · 1 1/2" 38mm · 2" 51mm · 2 1/2" 63mm · 3" 76mm · 3 1/2" 89mm
2. Special spigot size "G" available from 1" 25.4mm ~ 5" 127mm
3. Custom sizes available if Radius (R & R1) are kept unchanged.
4. The spigot height are needed, while ordering.



FIXED PORTS

AFLS



AFLS, AFLSO, AFLSR

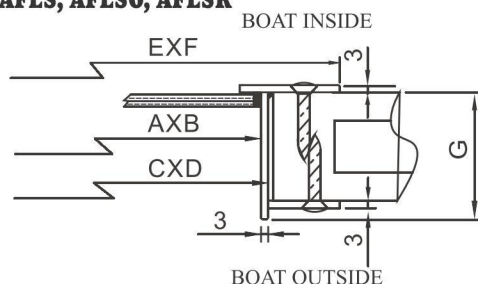

BFLS



MODEL No.		A x B MODEL		C x D CUT OUT SIZE		E x F OVERALL		R	R1	GLASS THICKNESS
AFLS-0512	BFLS-0512	5X12	127X305	5 1/4 X 12 1/8	133x307	7 5/8 X 14 1/2	193x368	1 1/4 32	2 3/8 62	1/4 6
AFLS-0714	BFLS-0714	7X14	178X356	7 1/4 X 14 1/4	184x362	9 5/8 X 16 5/8	244x424	1 1/4 32	2 3/8 62	1/4 6
AFLS-0716	BFLS-0716	7X16	178X406	7 1/4 X 16 1/4	184x413	9 5/8 X 18 5/8	244x473	1 1/4 32	2 3/8 62	1/4 6
AFLS-0718	BFLS-0718	7X18	178X457	7 1/4 X 18 1/4	184x464	9 5/8 X 20 5/8	244x524	1 1/4 32	2 3/8 62	1/4 6
AFLS-0816	BFLS-0816	8X16	203X406	8 1/4 X 16 1/4	210x413	10 5/8 X 18 5/8	269x473	1 1/4 32	2 3/8 62	1/4 6
AFLS-0818	BFLS-0818	8X18	203X457	8 1/4 X 18 1/4	210x464	10 5/8 X 20 5/8	269x524	1 1/4 32	2 3/8 62	1/4 6
AFLS-1020	BFLS-1020	10X20	254X508	10 5/16 X 20 5/16	262x516	12 7/8 X 22 7/8	327x581	1 1/4 32	2 1/2 65	3/8 10
AFLS-1024	BFLS-1024	10X24	254X609	10 5/16 X 24 5/16	262x617	12 7/8 X 26 7/8	327x682	1 1/4 32	2 1/2 65	3/8 10
AFLS-1224	BFLS-1224	12X24	305X609	12 5/16 X 24 5/16	313x617	14 7/8 X 26 7/8	378x682	1 1/4 32	2 1/2 65	3/8 10
AFLS-1228	BFLS-1228	12X28	305X710	12 5/16 X 28 5/16	313x718	14 7/8 X 30 7/8	378x783	1 1/4 32	2 1/2 65	3/8 10

IN/MM

AFLSO



BFLS, BFLSO, BFLSR

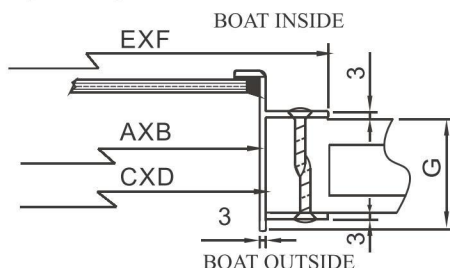

BFLSO



MODEL No.		A x B MODEL		C x D CUT OUT SIZE		E x F OVERALL		R	R1	GLASS THICKNESS
AFLSO-0512	BFLSO-0512	5X12	127X305	5 1/4 X 12 1/8	133x307	7 5/8 X 14 1/2	193x368	2 5/8 67	3 7/8 98	1/4 6
AFLSO-0714	BFLSO-0714	7X14	178X356	7 1/4 X 14 1/4	184x362	9 5/8 X 16 5/8	244x424	3 5/8 92	4 7/8 124	1/4 6
AFLSO-0716	BFLSO-0716	7X16	178X406	7 1/4 X 16 1/4	184x413	9 5/8 X 18 5/8	244x473	3 5/8 92	4 7/8 124	1/4 6
AFLSO-0718	BFLSO-0718	7X18	178X457	7 1/4 X 18 1/4	184x464	9 5/8 X 20 5/8	244x524	3 5/8 92	4 7/8 124	1/4 6
AFLSO-0816	BFLSO-0816	8X16	203X406	8 1/4 X 16 1/4	210x413	10 5/8 X 18 5/8	269x473	4 1/8 104	5 3/8 137	1/4 6
AFLSO-0818	BFLSO-0818	8X18	203X457	8 1/4 X 18 1/4	210x464	10 5/8 X 20 5/8	269x524	4 1/8 104	5 3/8 137	1/4 6
AFLSO-1020	BFLSO-1020	10X20	254X508	10 5/16 X 20 5/16	262x516	12 7/8 X 22 7/8	327x581	5 1/8 131	6 3/8 164	3/8 10
AFLSO-1024	BFLSO-1024	10X24	254X609	10 5/16 X 24 5/16	262x617	12 7/8 X 26 7/8	327x682	5 1/8 131	6 3/8 164	3/8 10
AFLSO-1224	BFLSO-1224	12X24	305X609	12 5/16 X 24 5/16	313x617	14 7/8 X 26 7/8	378x682	6 1/8 157	7 3/8 190	3/8 10
AFLSO-1228	BFLSO-1228	12X28	305X710	12 5/16 X 28 5/16	313x718	14 7/8 X 30 7/8	378x783	6 1/8 157	7 3/8 190	3/8 10

IN/MM

AFLSR

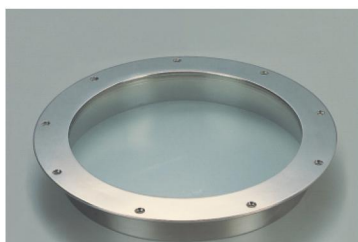

MODEL No.		A MODEL	C CUT OUT SIZE	E OVERALL	GLASS THICKNESS
AFLSR-0500	BFLSR-0500	5	5 1/4 133	7 5/8 193	1/4 6
AFLSR-0600	BFLSR-0600	6	6 1/4 158	8 5/8 218	1/4 6
AFLSR-0700	BFLSR-0700	7	7 1/4 184	9 5/8 244	1/4 6
AFLSR-0800	BFLSR-0800	8	8 1/4 210	10 5/8 269	1/4 6
AFLSR-1000	BFLSR-1000	10	10 5/16 262	12 7/8 327	3/8 10
AFLSR-1200	BFLSR-1200	12	12 5/16 313	14 7/8 378	3/8 10
AFLSR-1400	BFLSR-1400	14	14 5/16 364	16 7/8 428	3/8 10

BFLSR



IN/MM

VENTILATOR

- 316 stainless steel machined rolled frames. Hand polishing to protect against corrosion.
- Powder coating either off white or black available.
- All cut out sizes C X D are same as Rectangular / Round / Oval / Elliptical port's, pls refer it to LS / LR / LO / LE type.

(LS) RECTANGULAR VENTILATOR

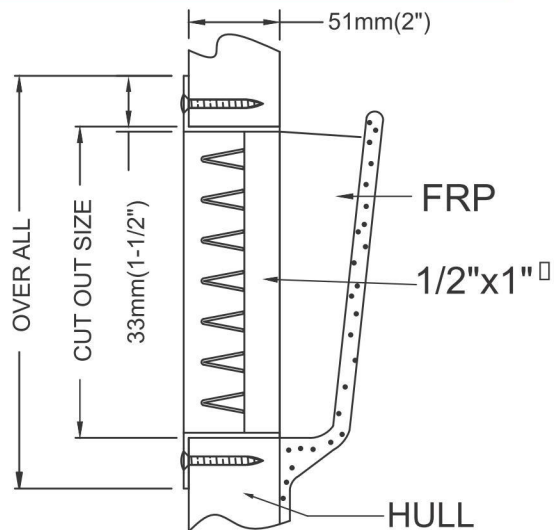

(LS-H) RECTANGULAR VENTILATOR



(LO) OVAL VENTILATOR



(LE) ELLIPTICAL VENTILATOR



(LR) ROUND VENTILATOR

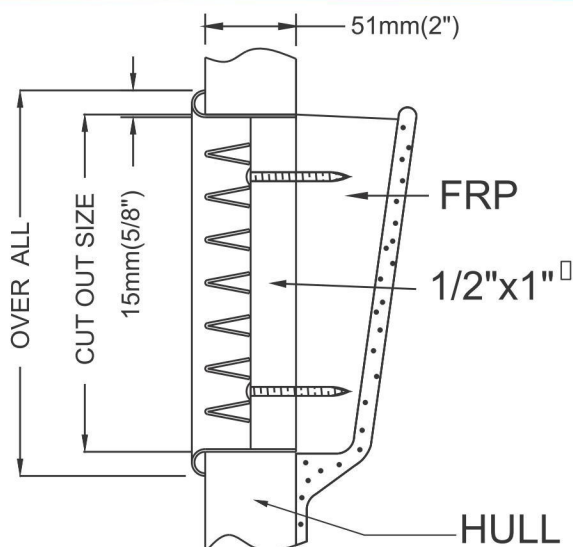

ELLIPTICAL, OVAL AND ROUND OPENING PORTS (H-TRIM)

- **CE Approved. According to ISO / DIS 12216**

LE, LO & LR type are supplied to Area III, IV. Designs for craft type "any".

- 316 stainless steel machined rolled ports. 316 stainless steel machine stamped frames. Hand Polished and electro polished to provide long lasting protection against corrosion.
- Weather resistant thermo-plastic Sanplane gasket.
- High Strength tempered glass.
- Optional fiberglass screens with rubber gaskets to ensure a tight fit on the opening port.

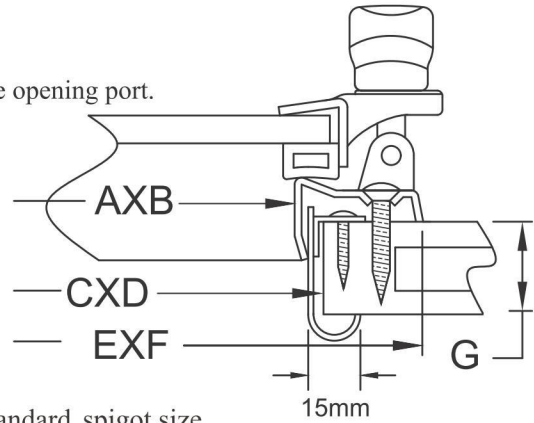

1. Standard spigot size
"G" available $1\frac{1}{4}$ " 32mm · $1\frac{1}{2}$ " 38mm · 2" 51mm · $2\frac{1}{2}$ " 63mm · 3" 76mm · $3\frac{1}{2}$ " 89mm
2. Special spigot size "G" available from 1" 25mm ~ 5" 125mm
3. The spigot height are needed, while ordering.

MODEL No.	A x B MODEL	C x D CUT OUT	E x F OVERALL	GLASS THICKNESS
LE-0718	7 X 17 ³ / ₄ 178X451	7 ³ / ₈ X 18 187X458	9 ⁵ / ₈ X 20 ³ / ₈ 244X518	⁵ / ₁₆ 8

IN / MM



MODEL No.	A MODEL	C CUT OUT	F OVERALL	GLASS THICKNESS
LR-0500	5 127mm	5 ⁵ / ₈ 143	7 ⁷ / ₈ 200	⁵ / ₁₆ 8
LR-0600	6 153mm	6 ⁵ / ₈ 168	8 ⁷ / ₈ 225	⁵ / ₁₆ 8
LR-0700	7 178mm	7 ⁵ / ₈ 194	9 ⁷ / ₈ 251	⁵ / ₁₆ 8
LR-0800	8 203mm	8 ⁵ / ₈ 219	10 ⁷ / ₈ 276	⁵ / ₁₆ 8

IN / MM



MODEL No.	A x B MODEL	C x D CUT OUT	E x F OVERALL	GLASS THICKNESS
LO-0512	5 X 12 127x305	5 ⁵ / ₈ X 12 ⁵ / ₈ 143x321	7 ⁷ / ₈ X 14 ⁷ / ₈ 200x378	⁵ / ₁₆ 8
LO-0614	6 X 14 153x356	6 ⁵ / ₈ X 14 ⁵ / ₈ 168x371	8 ⁷ / ₈ X 16 ⁷ / ₈ 225x429	⁵ / ₁₆ 8
LO-0714	7 X 14 178x356	7 ⁵ / ₈ X 14 ⁵ / ₈ 194x371	9 ⁷ / ₈ X 16 ⁷ / ₈ 251x429	⁵ / ₁₆ 8
LO-0716	7 X 16 178x406	7 ⁵ / ₈ X 16 ⁵ / ₈ 194x422	9 ⁷ / ₈ X 18 ⁷ / ₈ 251x479	⁵ / ₁₆ 8
LO-0718	7 X 18 178x457	7 ⁵ / ₈ X 18 ⁵ / ₈ 194x473	9 ⁷ / ₈ X 20 ⁷ / ₈ 251x530	⁵ / ₁₆ 8
LO-0816	8 X 16 203x406	8 ⁵ / ₈ X 16 ⁵ / ₈ 219x422	10 ⁷ / ₈ X 18 ⁷ / ₈ 276x479	⁵ / ₁₆ 8
LO-0818	8 X 18 203x457	8 ⁵ / ₈ X 18 ⁵ / ₈ 219x473m	10 ⁷ / ₈ X 20 ⁷ / ₈ 276x530	⁵ / ₁₆ 8

IN / MM



LO Oval portholes



LE Elliptical portholes
boat outside view

OPENING PORTS (H-TRIM) WITH STORM COVERS

- **CE Approved. According to ISO / DIS 12216**
CLE, CLR & CLO type are applied to Area I, II, III, IV. Designs for craft type "any".
- Each cover is machine stamped 316 stainless steel. Hand Polished and electro polished to provide long lasting protection against corrosion.
- All other features are the same as our **RECTANGULAR OPENING PORTS**.



MODEL No.	A x B MODEL	C x D CUT OUT	E x F OVERALL	GLASS THICKNESS
CLE-0718	7 X 17 ³ / ₄ 178x451	7 ³ / ₈ X 18 187x458	9 ⁵ / ₈ X 20 ³ / ₈ 244x518	5 ¹ / ₁₆

IN / MM

- Fixed or removable storm cover available.

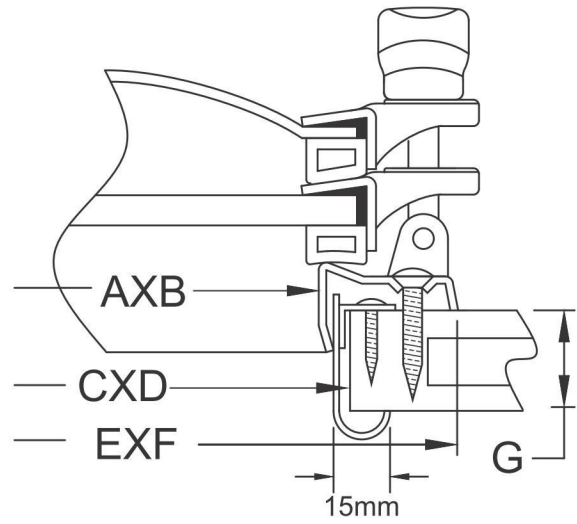

1. Standard spigot size
"G" available 1 ¹/₄" 32mm · 1 ¹/₂" 38mm · 2" 51mm · 2 ¹/₂" 63mm · 3" 76mm · 3 ¹/₂" 89mm
2. Special spigot size "G" available from 1 ¹/₂₅mm ~ 5" 125mm
3. The spigot height are needed, while ordering.



MODEL No.	A x B MODEL	C x D CUT OUT	E x F OVERALL	GLASS THICKNESS
CLO-0716	7 X 16 178x406	7 ⁵ / ₈ X 16 ⁵ / ₈ 194x422	9 ⁷ / ₈ X 18 ⁷ / ₈ 251x479	5 ¹ / ₁₆
CLO-0718	7 X 18 178x457	7 ⁵ / ₈ X 18 ⁵ / ₈ 194x473	9 ⁷ / ₈ X 20 ⁷ / ₈ 251x530	5 ¹ / ₁₆
CLO-0816	8 X 16 203x406	8 ⁵ / ₈ X 16 ⁵ / ₈ 219x422	10 ⁷ / ₈ X 18 ⁷ / ₈ 276x479	5 ¹ / ₁₆
CLO-0818	8 X 18 203x457	8 ⁵ / ₈ X 18 ⁵ / ₈ 219x473	10 ⁷ / ₈ X 20 ⁷ / ₈ 276x530	5 ¹ / ₁₆

IN / MM



MODEL No.	A MODEL	C CUT OUT	F OVERALL	GLASS THICKNESS
CLR-0800	8 203	8 ⁵ / ₈ 219	10 ⁷ / ₈ 276	5 ¹ / ₁₆ 8

IN / MM

ECONOMY OPENING PORTS (H-TRIM)

• **CE Approved. According to ISO / DIS 12216**

EE, EO & ER type are applied to Area III, IV . Designs for craft type "any".

- 316 stainless steel machine stamped frames, ports and hinges. Hand Polished and electro polished to provide long lasting protection against corrosion.
- Wing type nylon closures.
- Weather resistant thermo-plastic Sanplane gasket.
- Clear or Tanned Acrylic.



MODEL No.	A x B MODEL	C x D CUT OUT	E x F OVERALL	ACRYLIC THICKNESS
EE-0718	7 X 17 ³ / ₄ 178x459	7 ³ / ₈ X 18 188x458	9 ⁵ / ₈ X 20 ³ / ₈ 244x518	1/2 12

IN/MM

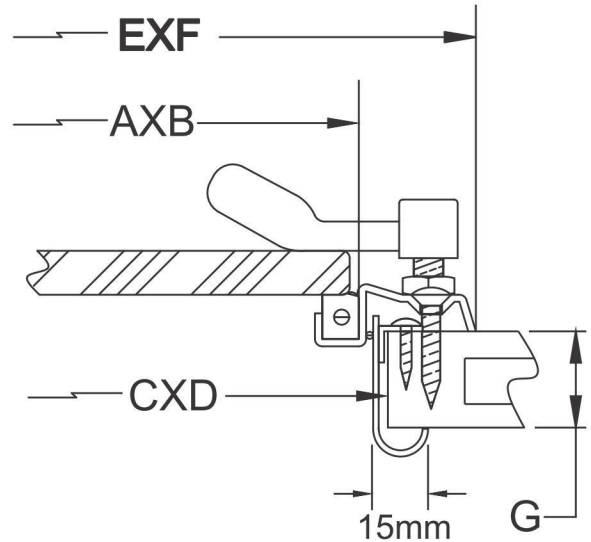

1. Standard spigot size

"G" available 1 1/4" 32mm · 1 1/2" 38mm · 2" 51mm · 2 1/2" 63mm · 3" 76mm · 3 1/2" 89mm

2. Special spigot size "G" available from 1 1/8" 25mm ~ 5 1/8" 125mm

3. The spigot height are needed, while ordering.



MODEL No.	A x B MODEL	C x D CUT OUT	E x F OVERALL	ACRYLIC THICKNESS
EO-0512	5 X 12 127x305	5 ³ / ₈ X 12 ³ / ₈ 137x315	7 ⁷ / ₈ X 14 ⁷ / ₈ 200x378	1/2 12
EO-0614	6 X 14 153x356	6 ³ / ₈ X 14 ³ / ₈ 162x365	8 ⁷ / ₈ X 16 ⁷ / ₈ 225x429	1/2 12
EO-0714	7 X 14 178x356	7 ³ / ₈ X 14 ³ / ₈ 188x365	9 ⁷ / ₈ X 16 ⁷ / ₈ 251x429	1/2 12
EO-0716	7 X 16 178x406	7 ³ / ₈ X 16 ³ / ₈ 188x416	9 ⁷ / ₈ X 18 ⁷ / ₈ 251x479	1/2 12
EO-0718	7 X 18 178x457	7 ³ / ₈ X 18 ³ / ₈ 188x467	9 ⁷ / ₈ X 20 ⁷ / ₈ 251x530	1/2 12
EO-0816	8 X 16 203x406	8 ³ / ₈ X 16 ³ / ₈ 213x416	10 ⁷ / ₈ X 18 ⁷ / ₈ 276x479	1/2 12
EO-0818	8 X 18 203x457	8 ³ / ₈ X 18 ³ / ₈ 213x467	10 ⁷ / ₈ X 20 ⁷ / ₈ 276x530	1/2 12

IN/MM



MODEL No.	A MODEL	C CUT OUT	F OVERALL	ACRYLIC THICKNESS
ER-0500	5 127	5 ³ / ₈ 137	7 ⁷ / ₈ 200	1/2 12
ER-0600	6 153	6 ³ / ₈ 162	8 ⁷ / ₈ 225	1/2 12
ER-0700	7 178	7 ³ / ₈ 188	9 ⁷ / ₈ 251	1/2 12
ER-0800	8 203	8 ³ / ₈ 213	10 ⁷ / ₈ 276	1/2 12

IN/MM

FIXED TYPE PORTHOLES (H-TRIM)

- 316 machined stamped stainless steel frames and trim rings. Hand Polished and electro polished to provide long lasting protection against corrosion.
- High Strength tempered glass.
- Additional fixed or removable storm cover available.

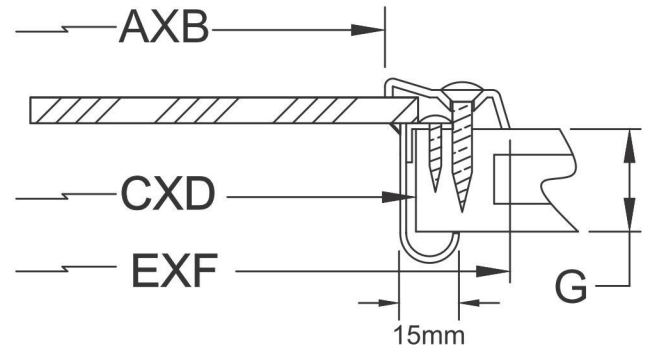
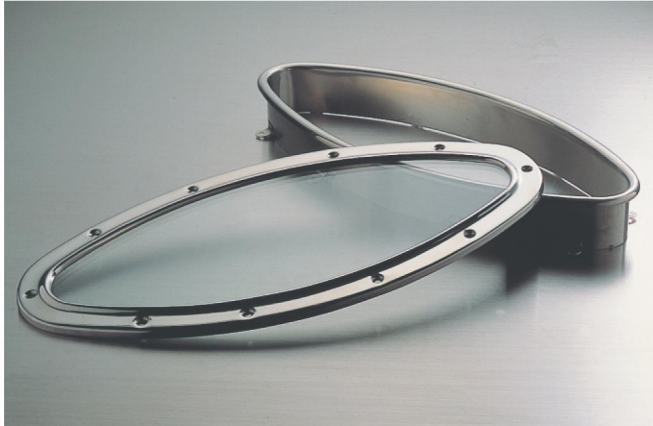

MODEL No.	A x B MODEL	C x D CUT OUT	E x F OVERALL	GLASS THICKNESS
FE-0718	7 X 17 ³ / ₄ 178X451	7 ³ / ₈ X 18 188X458	9 ⁵ / ₈ X 20 ³ / ₈ 244X518	1/4 6

IN/MM

1. Standard spigot size

"G" available 1¹/₄"_{32mm} · 1¹/₂"_{38mm} · 2"_{51mm} · 2¹/₂"_{63mm} · 3"_{76mm} · 3¹/₂"_{89mm}

2. Special spigot size "G" available from 1"_{25mm} ~ 5"_{125mm}

3. The spigot height are needed, while ordering.



MODEL No.	A x B MODEL	C x D CUT OUT	E x F OVERALL	GLASS THICKNESS
FO-0512	5 X 12 127X305	5 ³ / ₈ X 12 ³ / ₈ 137X315	7 ⁷ / ₈ X 14 ⁷ / ₈ 200X378	1/4 6
FO-0614	6 X 14 153X356	6 ³ / ₈ X 14 ³ / ₈ 162X365	8 ⁷ / ₈ X 16 ⁷ / ₈ 225X429	1/4 6
FO-0714	7 X 14 178X356	7 ³ / ₈ X 14 ³ / ₈ 188X365	9 ⁷ / ₈ X 16 ⁷ / ₈ 251X429	1/4 6
FO-0716	7 X 16 178X406	7 ³ / ₈ X 16 ³ / ₈ 188X416	9 ⁷ / ₈ X 18 ⁷ / ₈ 251X479	1/4 6
FO-0718	7 X 18 178X457	7 ³ / ₈ X 18 ³ / ₈ 188X467	9 ⁷ / ₈ X 20 ⁷ / ₈ 251X530	1/4 6
FO-0816	8 X 16 203X406	8 ³ / ₈ X 16 ³ / ₈ 213X416	10 ⁷ / ₈ X 18 ⁷ / ₈ 276X479	1/4 6
FO-0818	8 X 18 203X457	8 ³ / ₈ X 18 ³ / ₈ 213X467	10 ⁷ / ₈ X 20 ⁷ / ₈ 276X530	1/4 6

IN/MM

MODEL No.	A MODEL	C CUT OUT	F OVERALL	GLASS THICKNESS
FR-0500	5 127	5 ³ / ₈ 137	7 ⁷ / ₈ 200	1/4 6
FR-0600	6 153	6 ³ / ₈ 162	8 ⁷ / ₈ 225	1/4 6
FR-0700	7 178	7 ³ / ₈ 188	9 ⁷ / ₈ 251	1/4 6
FR-0800	8 203	8 ³ / ₈ 213	10 ⁷ / ₈ 276	1/4 6

IN/MM

STAINLESS STEEL BOAT WINDOW

(CUSTOM MADE)

- Easy dismount and reassemble glass for repair.
- S/S 316, mirror polished, anti-corrosion.
- Fixed, one fixed one sliding and two sliding windows available.
- No exposed seams or fasteners.
- Fixed window ensure water tightness.
- Drain channels of sliding window ensured drainage.
- Tempered glass 6mm, 10mm for fixed windows.
- Tempered glass 6mm for sliding windows.

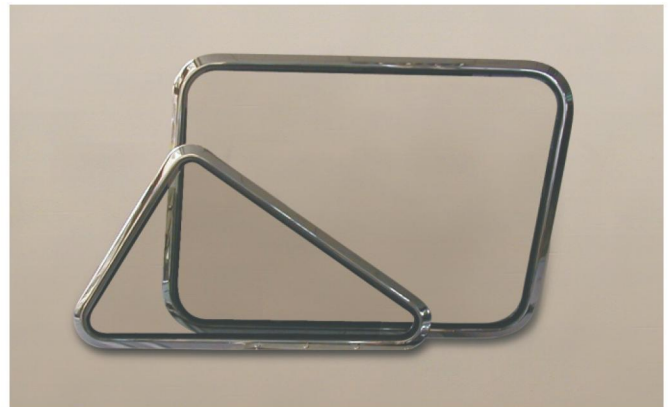

FIXED BOAT WINDOW



HINGED BOAT WINDOW



SLIDING BOAT WINDOW

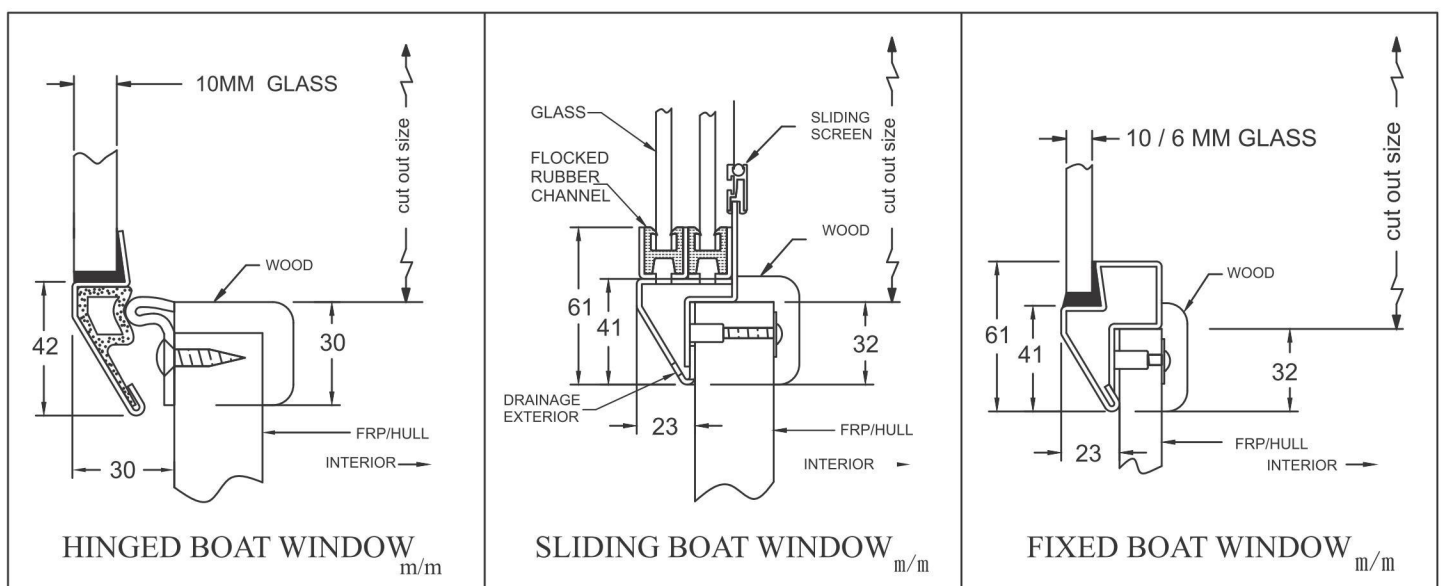

ALUMINUM BOAT WINDOWS

(CUSTOM MADE)

Aluminum Windows are made of 6063-T5 extruded aluminum alloy, clear or tanned tempered glass & weather-resistant Sanplane gasket.

Easy installation, attractive surface and water-resistant.

- Any shaped windows are available for sliding windows or fixed windows.
- Either in metallic anodized or off-white/black powder coating.
- Will assure better anti-corrosion.
- We can produce custom windows if drawings of window shape, corner degrees and cutout sizes are offered.



HINGED BOAT WINDOW



FIXED BOAT WINDOW



SLIDING BOAT WINDOW

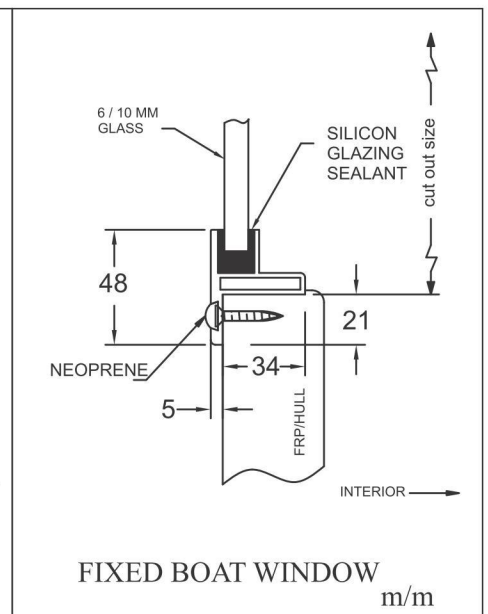
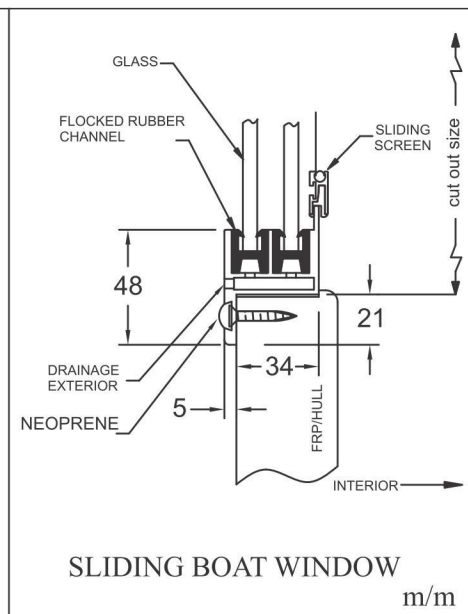
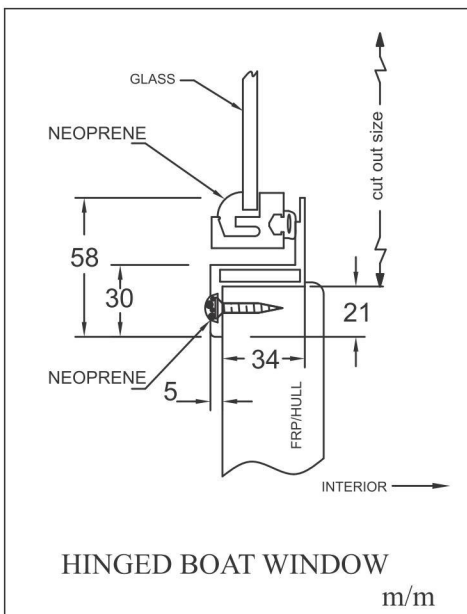

ALUMINUM HINGED, SLIDING & FIXED PORTS

- Man Ship portholes are manufactured from 6063 T5 extruded aluminum alloy and are attractively engineered for both safety and durability.
- Our easy to operate positive locking system ensures excellent water-tight characteristics.
- All our ports are heavily anodized to protect against corrosion and are available in either metallic or black and are fitted with tempered glass.
- We can manufacture custom sizes provided the corner radius remains unaltered.

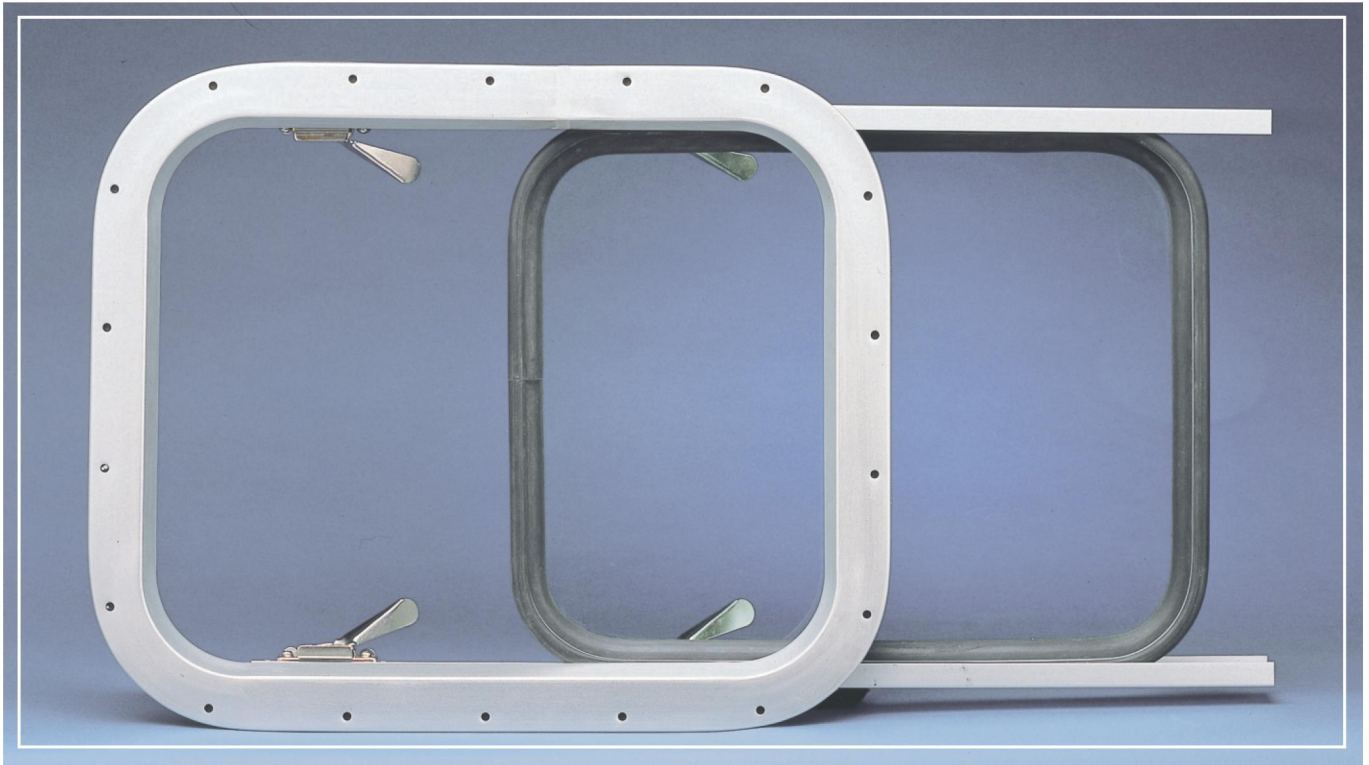

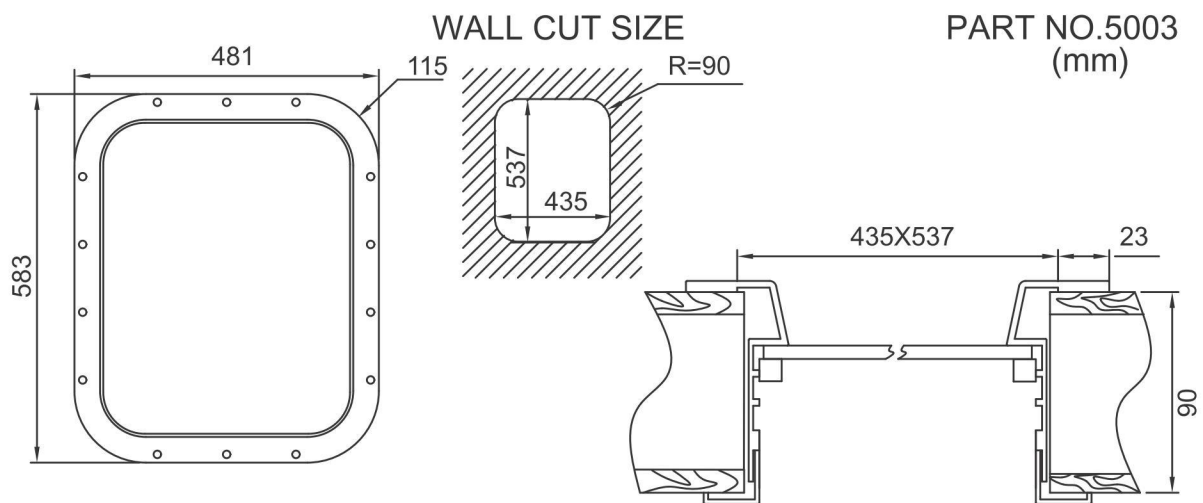
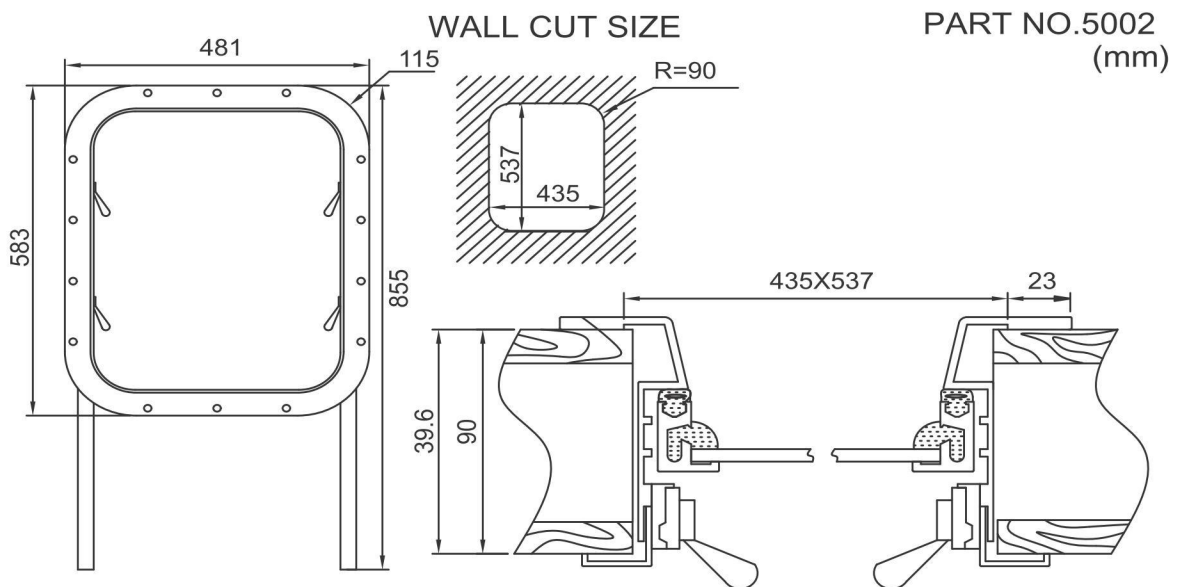
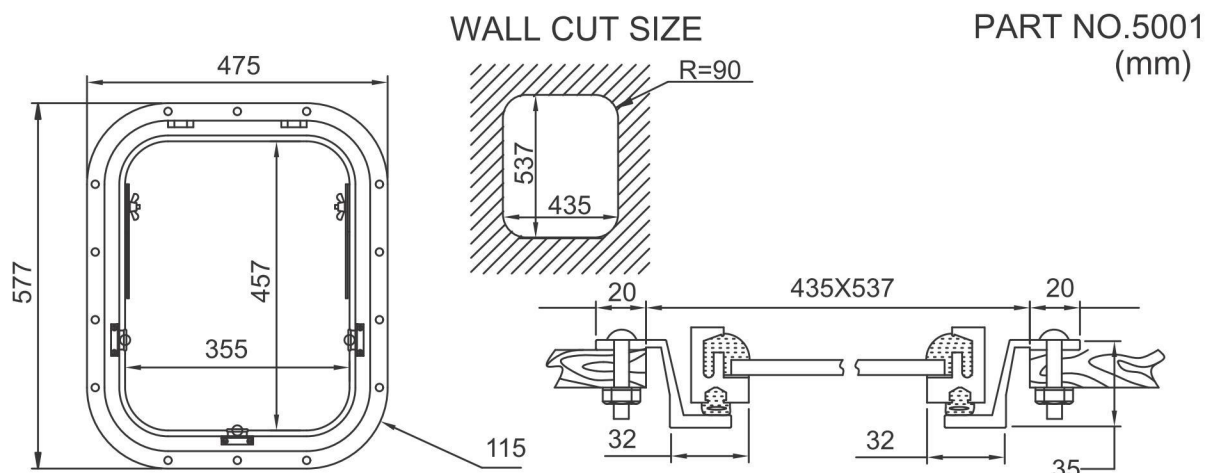

STAINLESS STEEL FLUSH GLASS SALOON DOOR (CUSTOM MADE)

- S/S 316, mirror polished, anti-corrosion.
- Tempered 8m/m glass, Color available.
- Excellent & elegant vingcard locking system.
- Adjustable bronze rollers, anti-corrosion, slide smooth.
- Knock-down frame, easy transport & assemble.
- Design of door available for various layout option.
- Door panel fully welded, strong and ensured water tightness.
- S/S 316 sliding insect screen for comfort.
- Single sliding, two sliding, one fixed one sliding, two fixed two sliding door available.



F100 SINGLE SLIDING



F300 TWO SLIDING



F100: single sliding

CUSTOM DOOR AVAILABLE.

PLEASE INFORM CUT OUT SIZE A X B TO QUOTE OR PRODUCE.

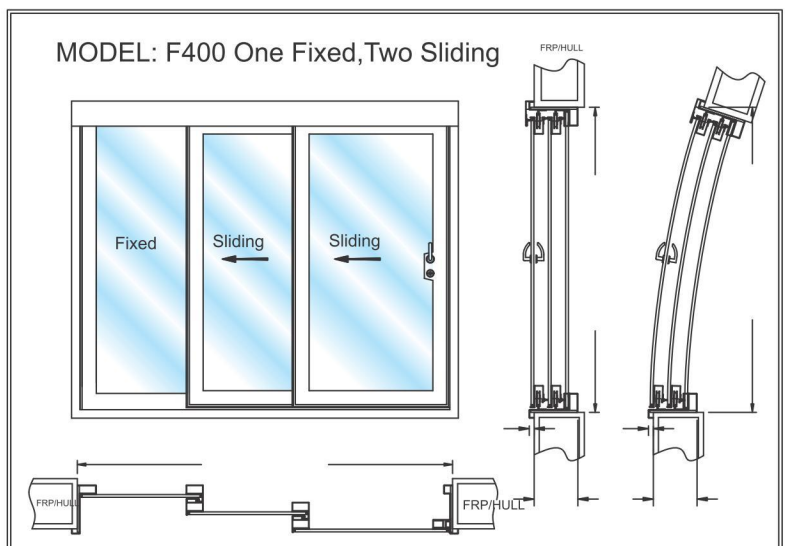
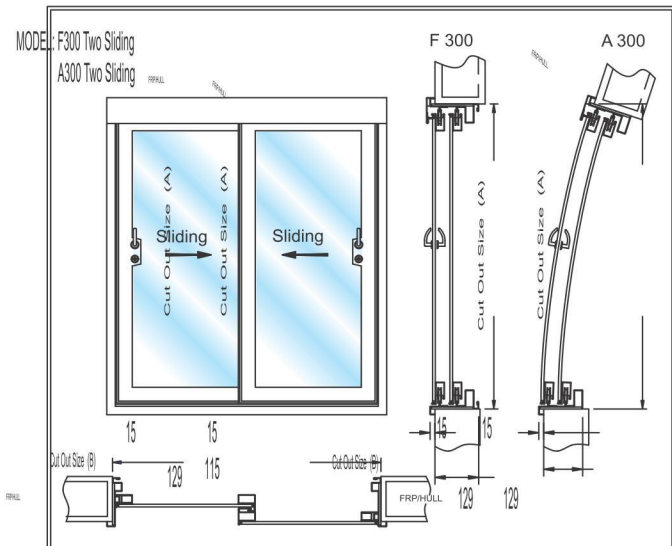
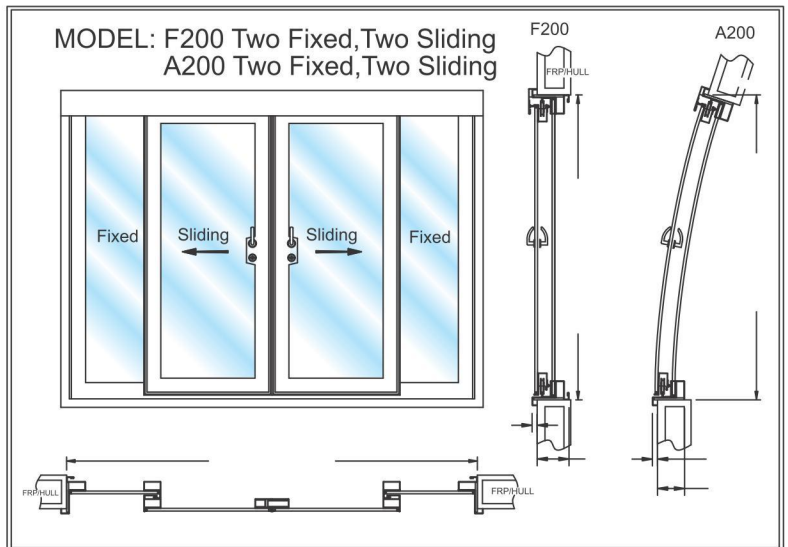
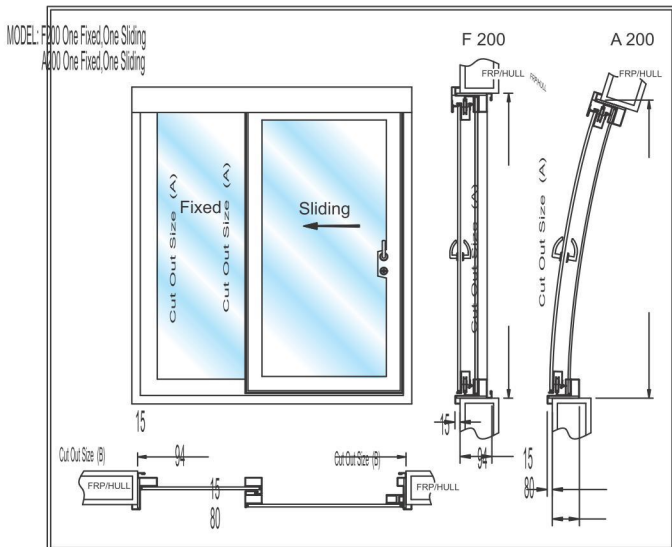
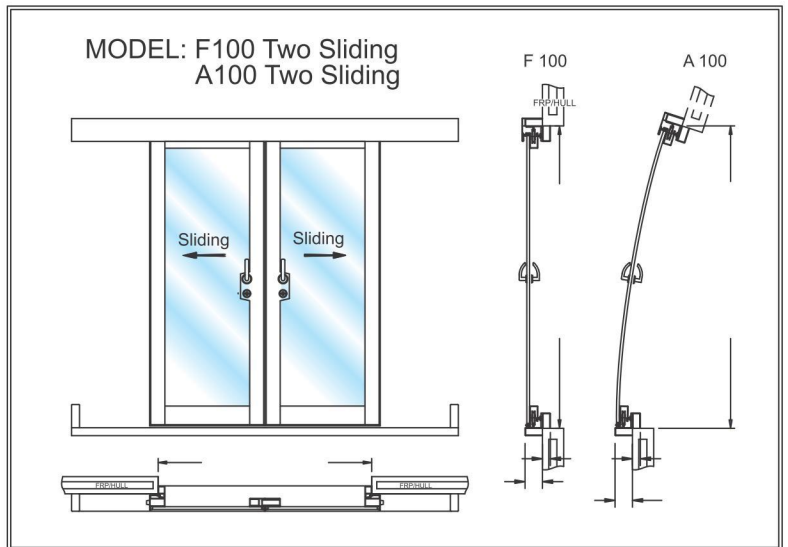
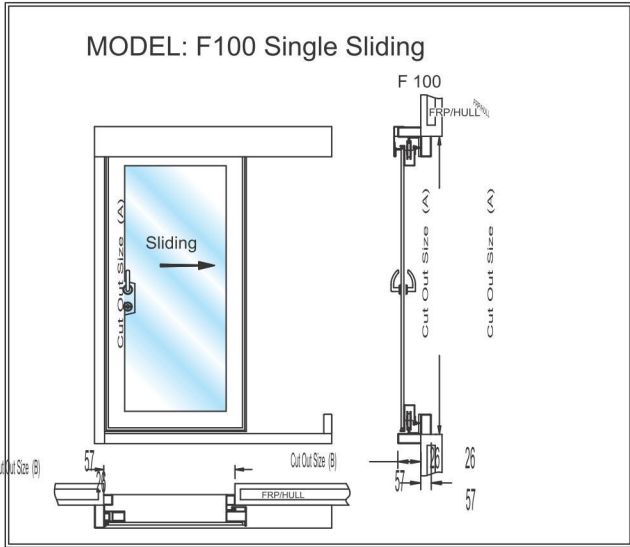

CIRCULAR ARC STAINLESS STEEL SALOON DOOR

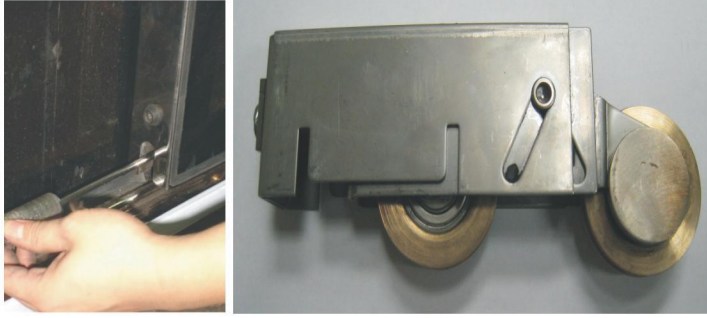

Four adjustable rollers installed in every saloon door, and the door can do some slightly adjustment for smooth moving.



MODEL: R100 TWO SLIDING

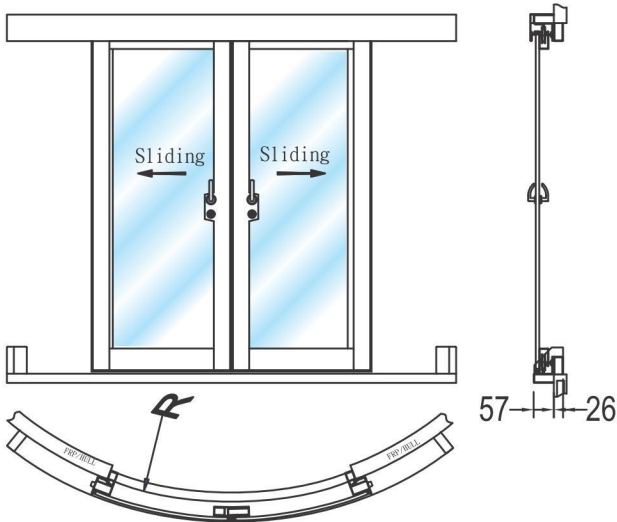

- S/S 316, surface treatment, mirror polished
- Tempered glass 8m/m, glass color available
- Elegant marine locking included
- Saloon door is water proof
- Design of saloon door available for various layout option
- Screen door can be chosen circular arc screen door (one sliding and two sliding available)

MODEL: R200 ONE FIXED, ONE SLIDING

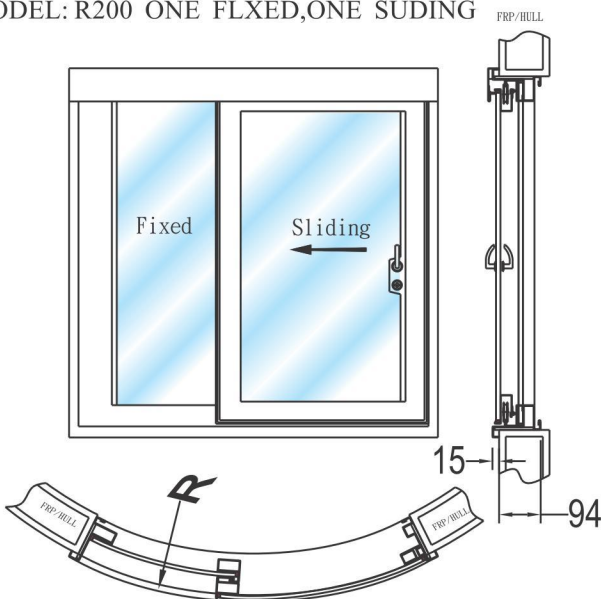

MODEL: R200 TOW FIXED, TOW SLIDING

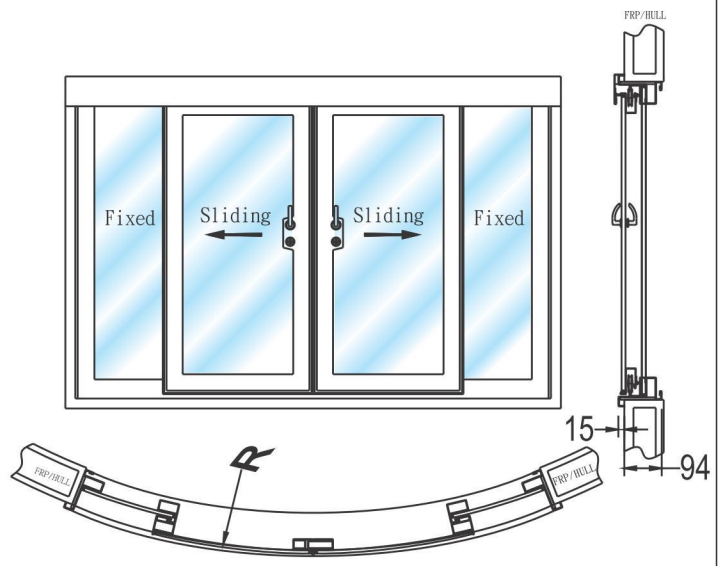

(CUSTOM MADE)



Screendoor(two sliding)

MODEL: R300 TWO SLIDING

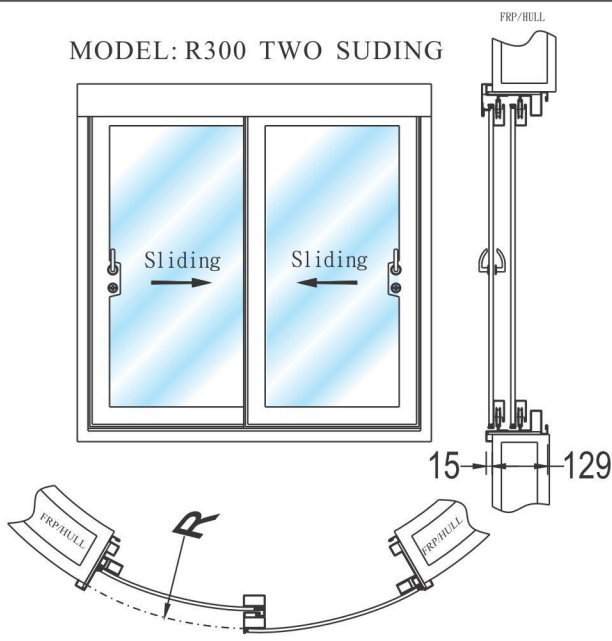

MODEL: R400 ONE FIXED, TWO SLIDING

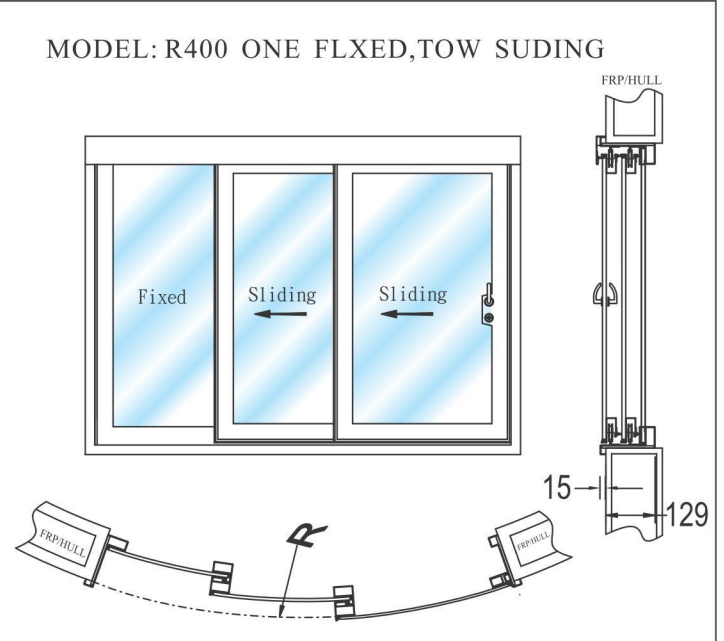

FRICATIVE HINGE STAINLESS STEEL SALOON DOOR

- S/S 316, surface treatment, mirror polished
- Tempered glass 6m/m, glass color available
- Strong and S/S 316 fricative hinge
- Gas arm for supporting window included
- Elegant marine locking included
- Saloon door is waterproof
- Design of saloon available for various layout option



Class colors available



MODEL: SFL100 ONE OPEN, ONE SLIDING, ONE FIXED

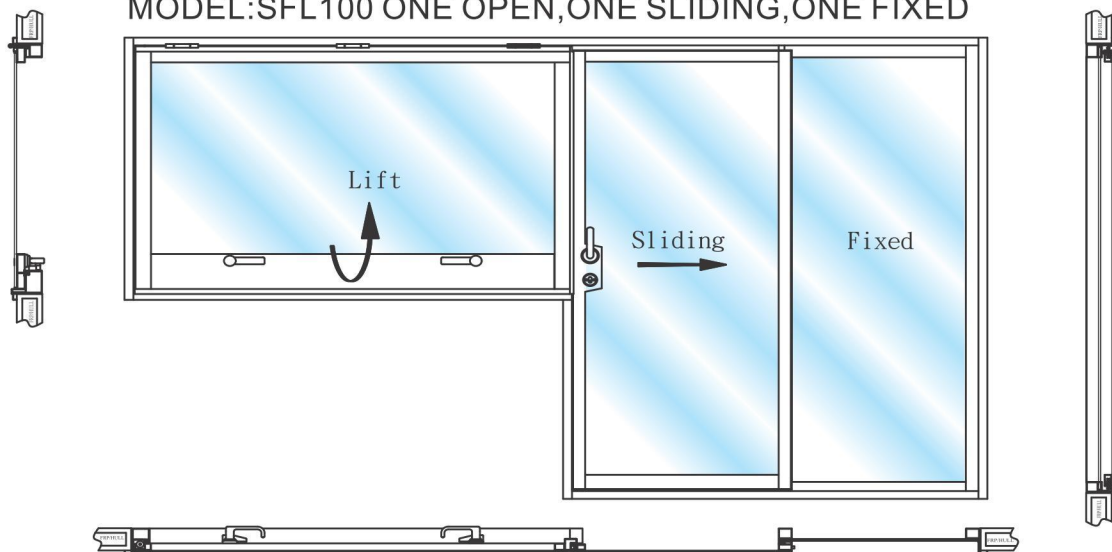

(CUSTOM MADE)



THE NOTES FOR ORDERING SALOON DOOR

- Please advise the saloon door model number, and the open/close function.
(one fixed, one sliding, or two fixed, two sliding)
- Please provide cutout size: A, B, C, D, R dimension and model number.

MODEL: F100F200F300F400

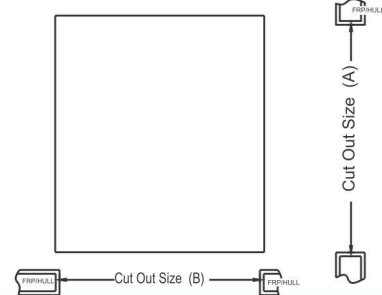

MODEL: A200A300A400

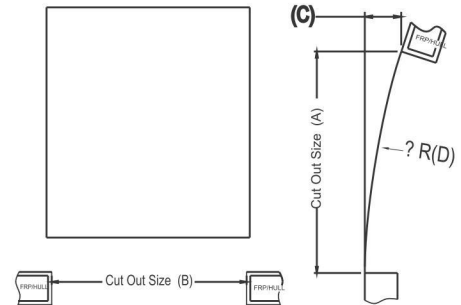

MODEL: R100R200R300R400

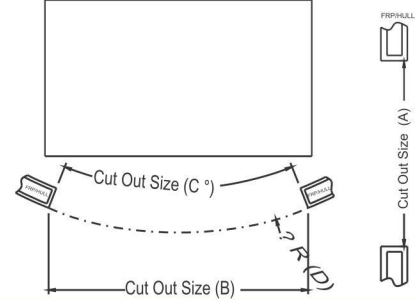

MODEL: OL100 TWO OPEN

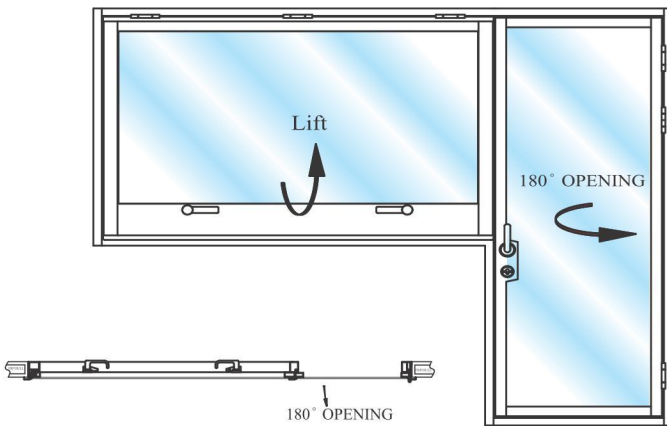

MODEL: SFL100OL100

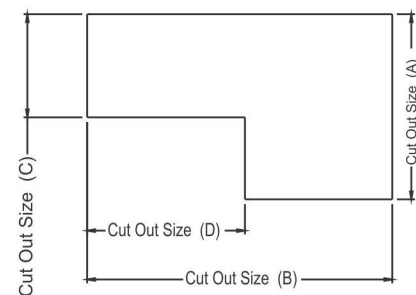

AUTOMATIC SLIDING WINDOW (CUSTOM MADE)



- New developed base material is Aluminum 65061T5, and the surface is black powder coating.
- Automatic sliding window is installed with stainless steel gear and chain started by 24-12V motor. It started 5mm tempered glass with lift function.
- Automatic sliding window can be used in badly marine and also have drain function.
- It is easy to install and repair. Please advise A1, A2, B and R cutout size. ManShip will provide the drawing and quote.

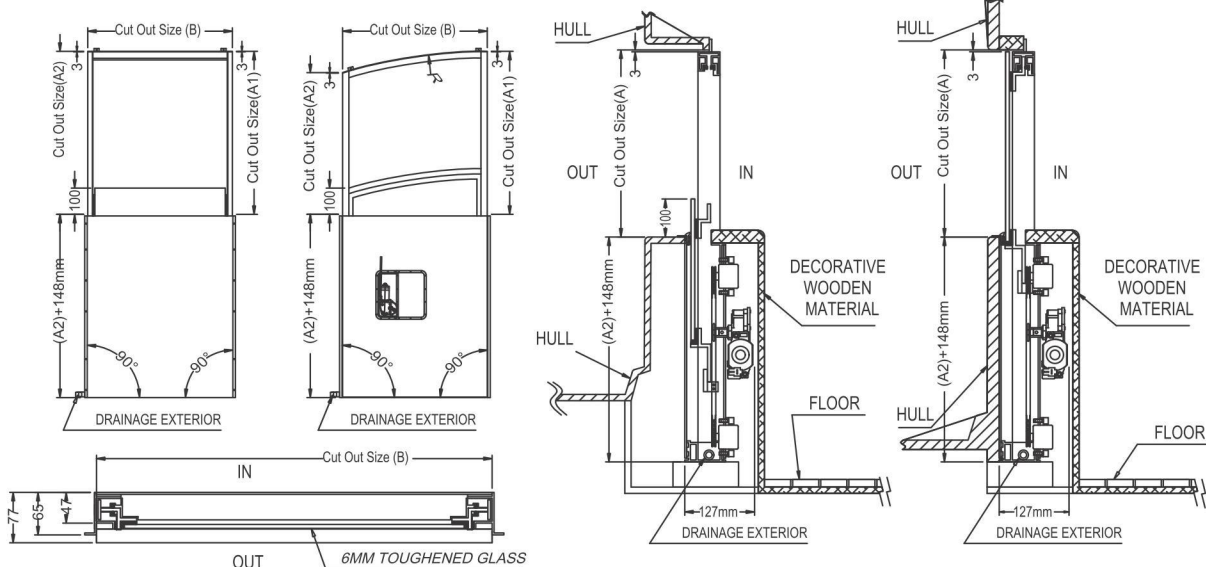

AUTOMATIC OPENING WINDOW (CUSTOM MADE)



New developed base material is stainless steel 316, and colors are available: stainless steel primary, white and black powder coating. Automatic opening window is installed in front of wheelhouse. The open distance is 135mm with ventilation function. Two arms moved by 24-12V motor. 5mm tempered glass with 100% watertight, strong and elegant. Please advise A and B cutout size. ManSHIP will provide the drawing and quote.

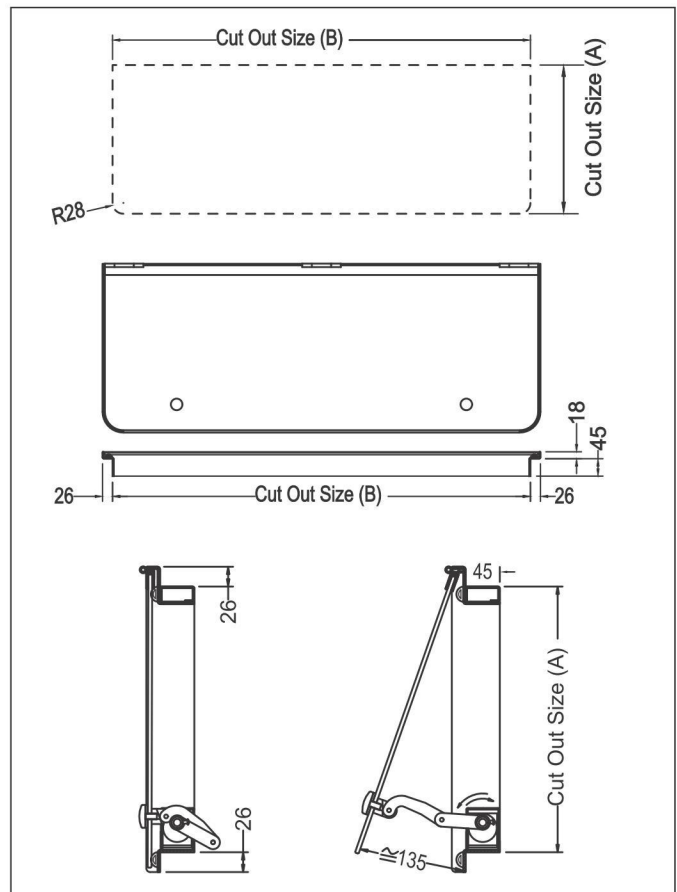

DECK FILLS

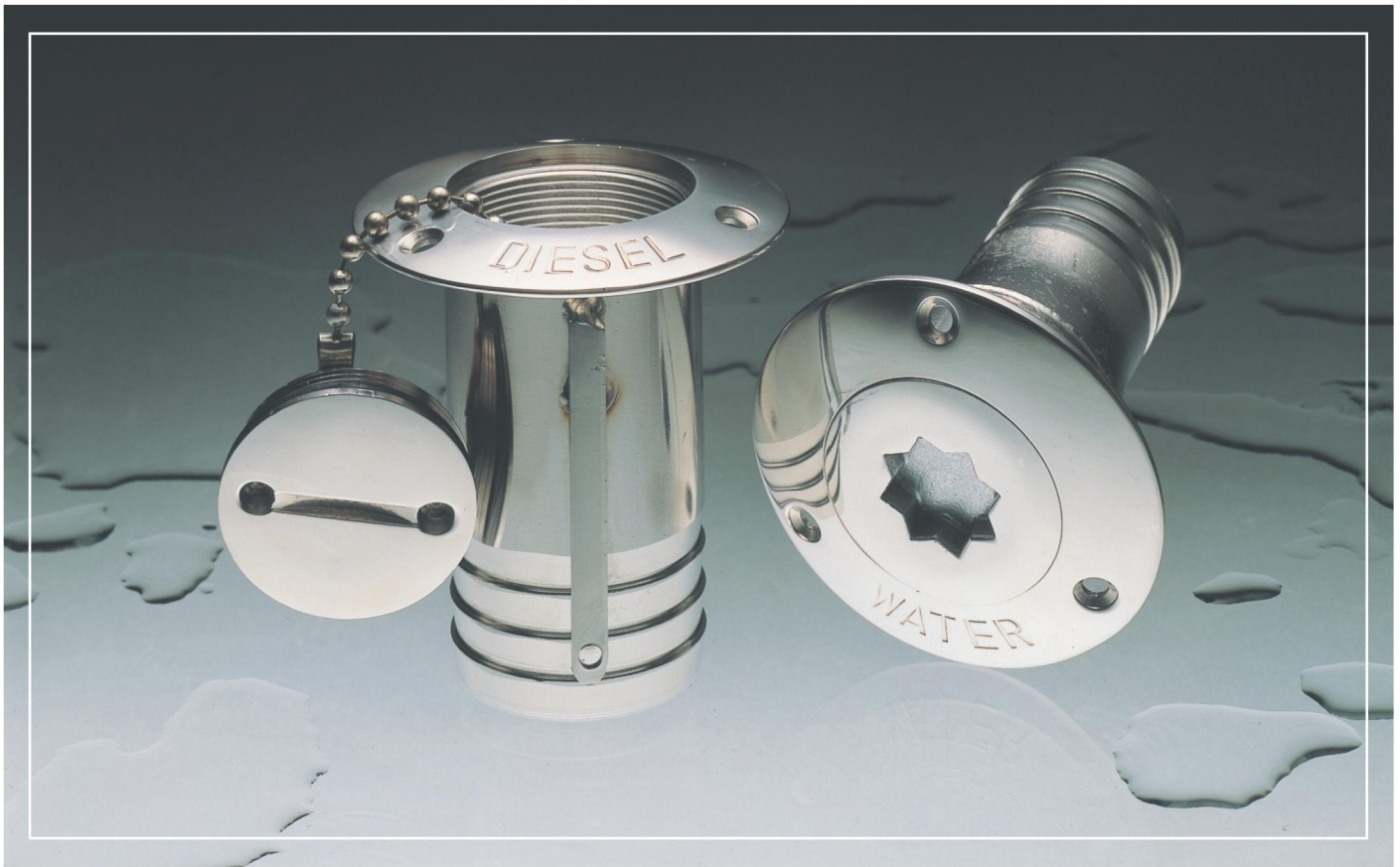

- 316 stainless steel. Hand polished and electro-polished to protect against corrosion.
- Each Deck Fill is marked with either: DIESEL, WATER, WASTE or ESSENCE.
- DIESEL Deck Fills come with a stainless steel tang for easy attachment of grounding wire.
- Each Deck Fill has an o-ring gasket for a tight seal.
- Your choice of Deck Fill cap: Standard type which opens with a key provided or Sailing yacht type which opens with any standard winch handle.

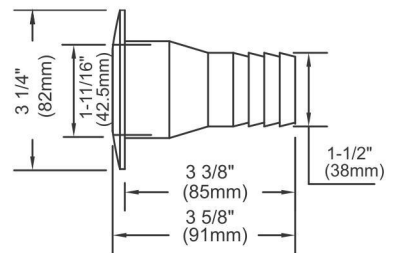
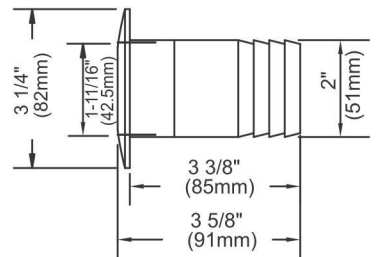
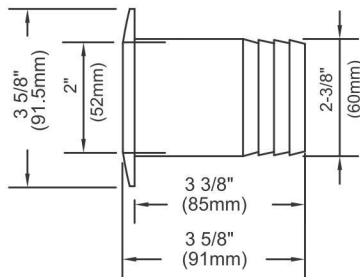

PART No.	PIPE SIZE	TYPE	MARK
6546-11	1 1/2 38	☼	WATER
6546-12	1 1/2 38	☼	DIESEL
6546-13	1 1/2 38	☼	WASTE
6546-14	1 1/2 38	☼	ESSENCE
6546-21	2 51	☼	WATER
6546-22	2 51	☼	DIESEL
6546-23	2 51	☼	WASTE
6546-24	2 51	☼	ESSENCE

PART No.	PIPE SIZE	TYPE	MARK
6547-11	1 1/2 38	☼	WATER
6547-12	1 1/2 38	☼	DIESEL
6547-13	1 1/2 38	☼	WASTE
6547-14	1 1/2 38	☼	ESSENCE
6547-21	2 51	☼	WATER
6547-22	2 51	☼	DIESEL
6547-23	2 51	☼	WASTE
6547-24	2 51	☼	ESSENCE

IN/MM

DORADES



FEATURES

- 18-8 non-magnetic stainless steel. Hand polished and electro-polished chrome plating to protect against corrosion.
- Snag-free design.
- Low profile with tear drop opening to allow maximum air to enter the dorade box.
- Stainless steel Deck Plate provided with O-ring.
- White or blue colored epoxy paint standard for the inside of the Dorade. Custom colors available on request by special order.

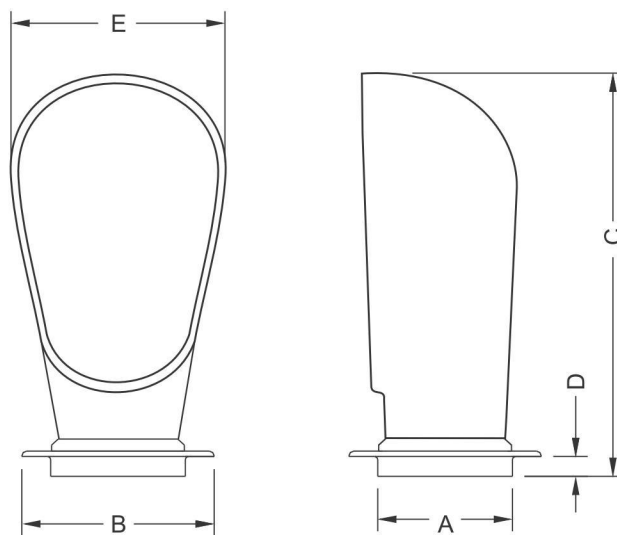

PART No.	A	B	C	D	E	COLOR					
6500-31	3 1/2	90	5	120	10 1/2	267	5/8	16	5 3/4	145	WHITE
6500-32	3 1/2	90	5	120	10 1/2	267	5/8	16	5 3/4	145	BLUE
6500-41	4 3/8	112	6 1/4	160	13 5/8	346	5/8	16	7 1/8	180	WHITE
6500-42	4 3/8	112	6 1/4	160	13 5/8	346	5/8	16	7 1/8	180	BLUE
6500-51	5 7/8	150	7 7/8	200	15 3/4	400	7/8	22	7 1/2	190	WHITE

IN/MM

TV LIFT

FEATURES

- MAN SHIP uses LINAK DESKLIFT DI4, DL11XL (two kinds of TV lift models) with 3-part telescopic column design combines to MANSHIP TV seat, compact and easily be installed.
- The power only can be used 120VAC/60Hz, 230VAC/50Hz.
- Low and uniform noise level.
- Hall sensor enables parallel drive with CBD4, up to 16 legs in a multiparallel system.
- Double acting brake for increased self-locking.
- Approved according to EN 60335-4 and UL 962.
- **MANSHIP also can custom make per customer's request and design TV lift spin function manually (180 degree).**

DL4 15 sec (toally raise)
1.7"/sec

TV the maximum height is 550~625 mm.
(21.6"~24.6")

The loading weight is 50kg.

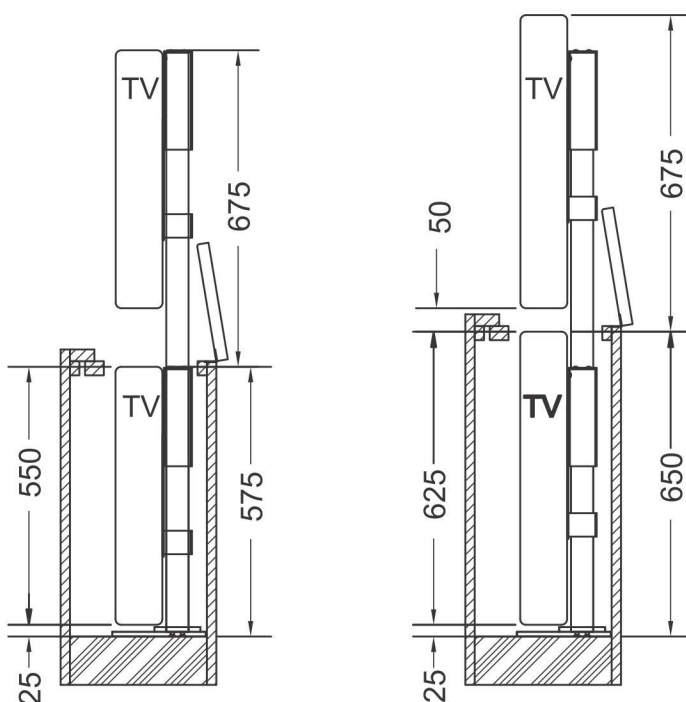
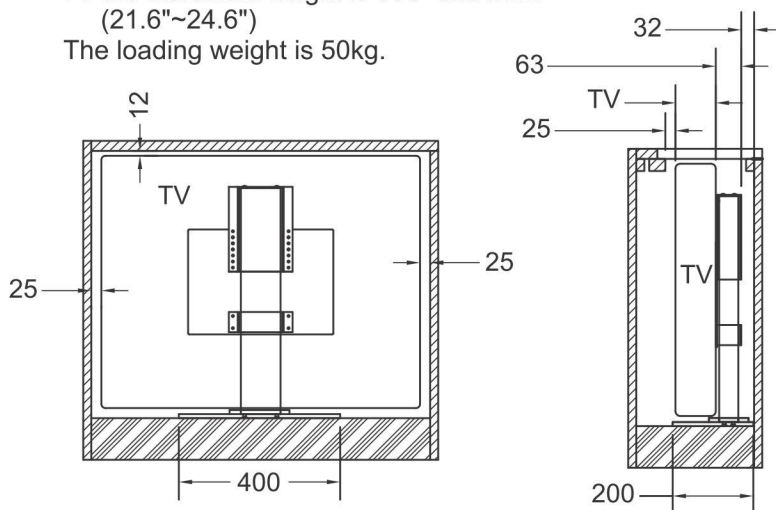

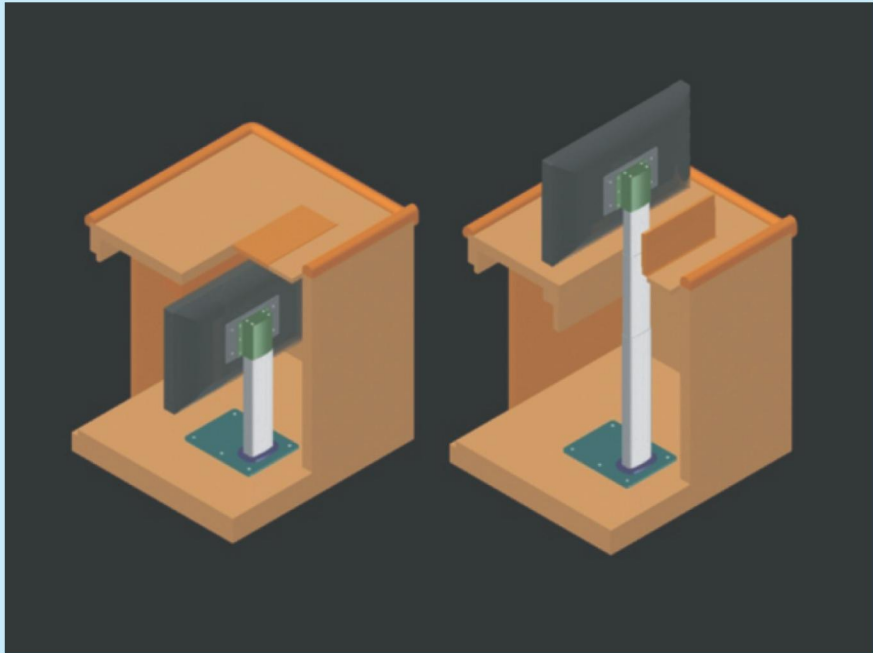

SYSTEM LAYOUT

The columns can also be placed upside down with the cable out of the bottom.

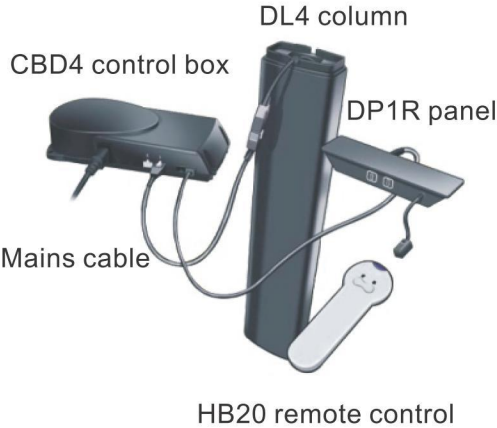

DL11XL 25 sec (toally raise)
 1.5"/sec
 TV the maximum height is 670~909mm.
 (26.3"~35.7")
 The loading weight is 50 kg.

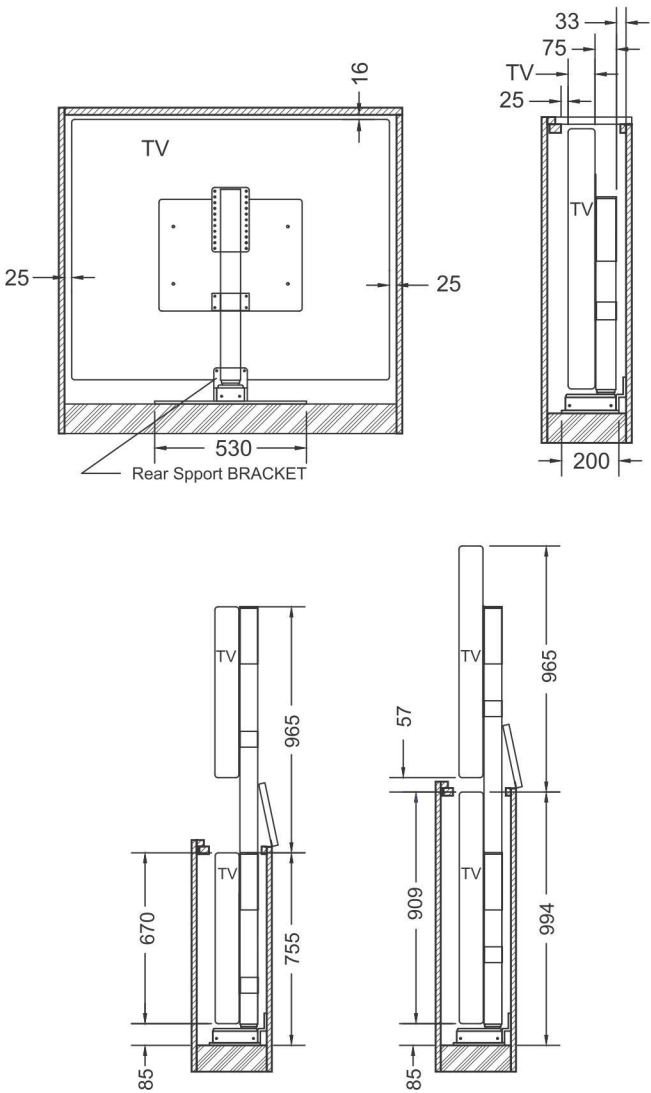

DOOR CABINET LATCH PUSH BUTTON

FEATURES

- Easy to install, safe, and attractive outline.
- Button trim and interior spring are made of stainless steel to avoid corrosion.
- Can be used for thickness from 1/2" to 1". Standard thickness is 3/4.
- Dual action latch positive locking with button fully depressed.(7100)
- It will hold the door without locking. To depress button will link s/s shaft with clamp to hook up s/s tap for positive locking.(7200)
- Optional colors: silver/chrome, gold/titanium plated.

7200-14
L=48"(1220mm)

CAUTION:

To prevent breakage or damage. Do not activate the latch before the door has closed.



• Cabinet Latch 7100

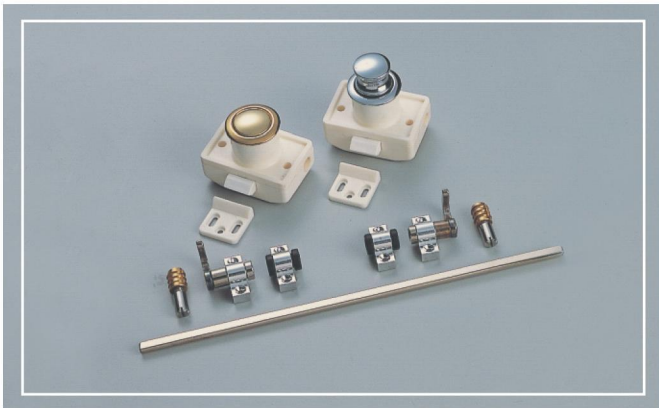

• Door Latch 7200



• Cabinet Latch 7300
• Door Latch 7400

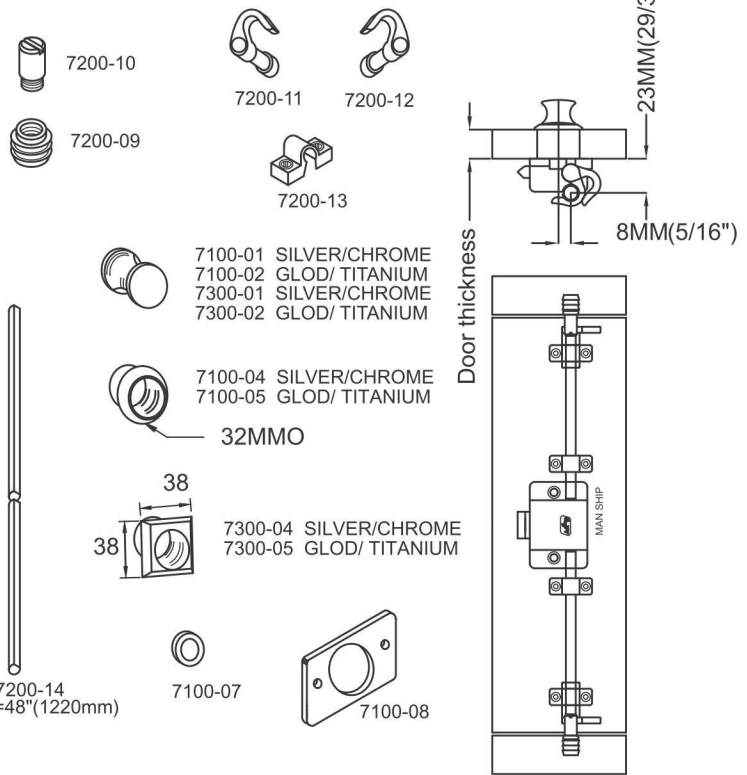
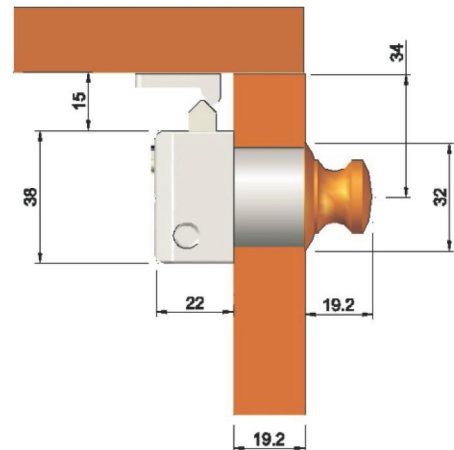

SPARE PARTS

HANDLE For inside / double open hatch

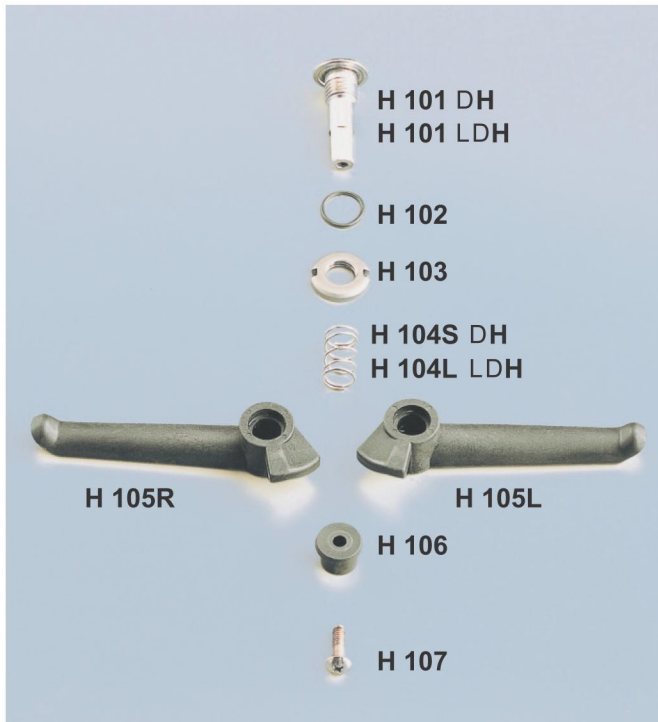

HANDLE For in / outside hatch



HATCH ARM



PORTLIGHT KNOBS



PART No.	APPLIED TO HATCHES			
301R&L	19 1/2 X 19 1/2 (495X495)	24 X 24 (610X610)	31 X 31 (788X788)	
301R	14 1/2 X 19 1/2 (369X495)	16 1/2 X 16 1/2 (419X419)		
302R	12 1/2 X 17 1/2 (318X414)			
303R	8 1/8 X 13 3/4 (206X349)			

IN/MM

P001、P002
PORTLIGHT KNOBS
H209
HINGE PIN For hatch double open
H109
HINGE PIN For hatch inside open



MAN SHIP

Machinery & Hardware co., Ltd.

No. 28.Chang Tay St., Hsiao Kang Dist., Kaohsiung, Taiwan, R.O.C.

Tel:(07)8715281-3 fax:(07)871-6818

e-mail:mash8197@ms12.hinet.net

web site:www.manshipmarine.com